

→ Wall Mounted Poles



Ideal for gaining an elevated viewpoint from existing structures, we offer a range of wall and parapet mounted products, both fixed and tilt-down to suit most applications. Many are available from stock and where a standard product does not suit, we provide variations on short lead times.

ACP Wall Mounted Poles

Ideal for gaining an elevated view point from existing structures.

ACP Part Numbering

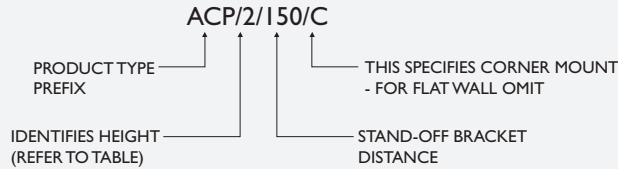

Stand-Off Bracket Options

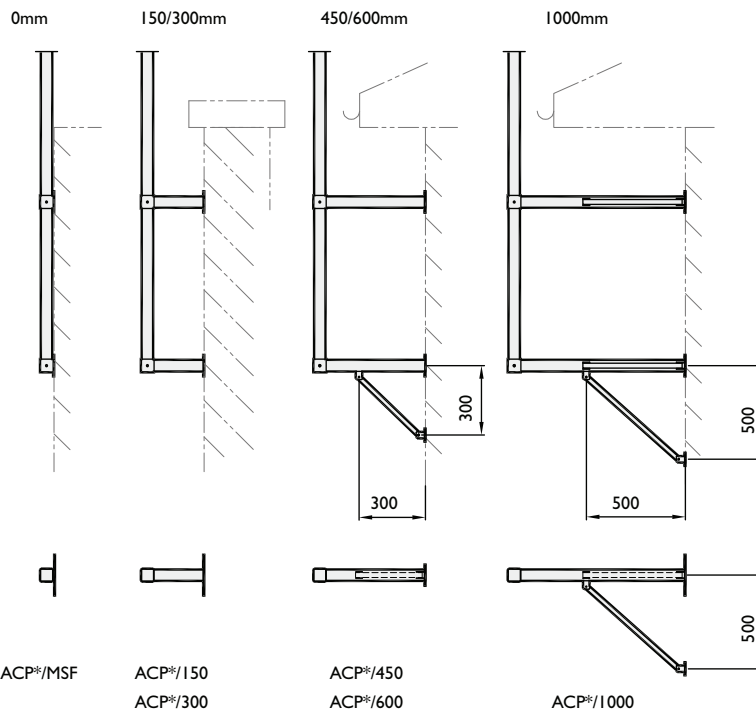

Wall Plate Details

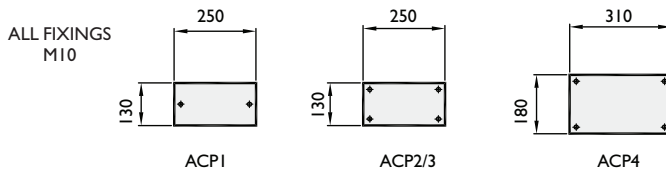

Corner Mount Bracket Details

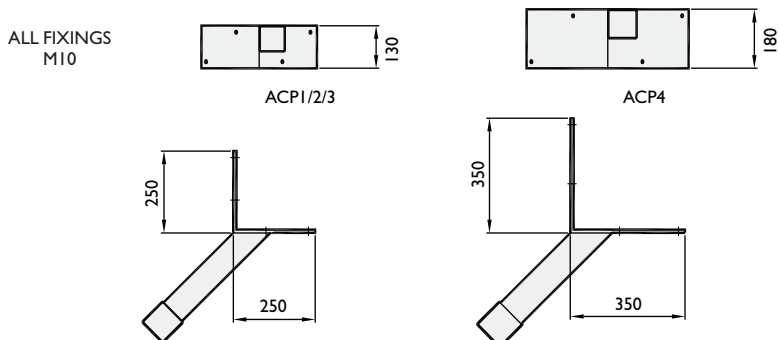

Features

- o Poles up to 6m shipped on carrier for overnight delivery
- o Rigid construction
- o Hot dip galvanised for longevity
- o Full range of accessories available

Model Number	H	B	A	C	D
ACP1	3m	70 ²	0.3m	1.7m	1m
ACP2	4m	80 ²	0.3m	2.2m	1.5m
ACP3	5m	80 ²	0.4m	2.6m	2m
ACP4	6m	90 ²	0.5m	3.5m	2m

● All variations held in stock

- o Dimension 'A' to be maintained for upper bracket fixing strength
- o Dimension 'D' to be maintained for camera stability

PTZ MOUNTING PLATE WITH 8 No. ø8.5 HOLES EQUI-SPACED ON A ø101.6 PCD.

**Max headload
25 kgs - 0.25m²**

