

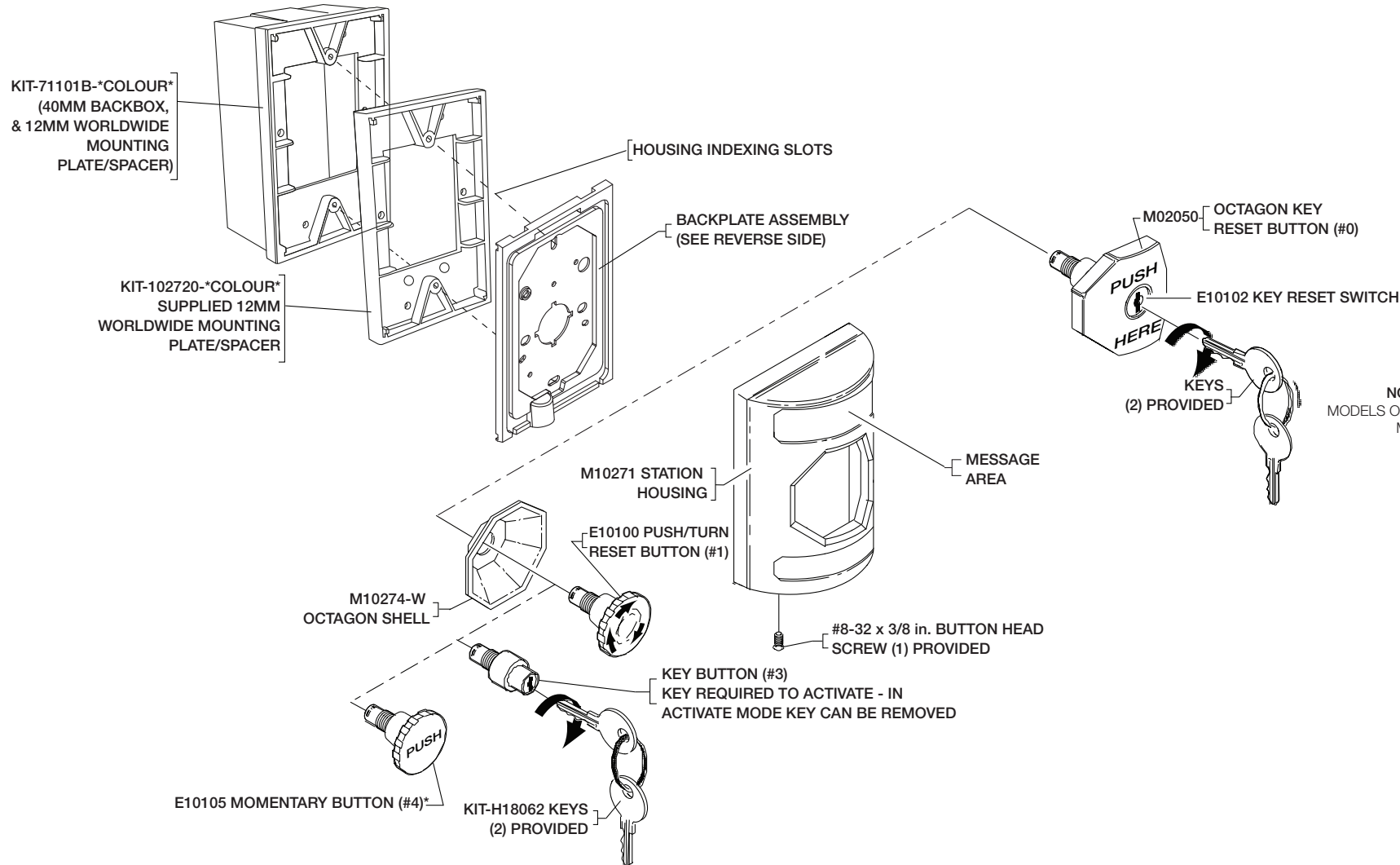

Safety Technology International

European Office
Taylor House • 34 Sherwood Road • Bromsgrove
Worcestershire • B60 3DR • England
Tel: 44 (0) 1527 520 999 Fax: 44 (0) 1527 501 999
E-mail: info@sti-emea.com • Web: www.sti-emea.com

USA - Headquarters
2306 Airport Road • Waterford, Michigan 48327-1209
Phone: 248-673-9898 • Fax: 248-673-1246
Toll Free: 800-888-4784 • E-mail: info@sti-usa.com
Web: www.sti-usa.com



PRODUCT DIMENSIONS

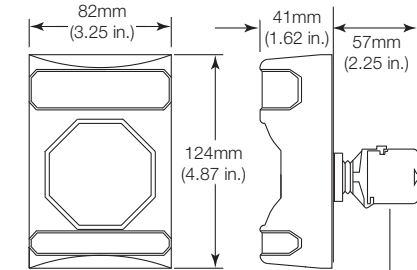

NOTE: MODELS REQUIRE KIT-71101B-*COLOUR*
MODELS ONLY SUITABLE FOR EXTENDED DEPTH SURFACE MOUNTING DUE TO DIMENSIONS OF CONTACTS

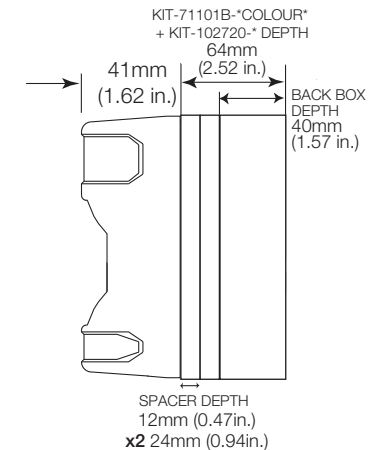

*SS-2**4 and LT1 NOTES: For access control installations, power for the LT-1UL Timer must be supplied by a power source listed to UL294. When used for access control, this device shall be used as part of an access controlled egress door system. It is up to the local AHJ to allow use of this device in place of an automatic sensor. For higher security installations, lower time limits should be used. For SS-2** and LT1-UL the enclosed timer is to be used and installed per the enclosed LT-1UL installation sheet. SS-2**4 and LT1-UL maximum rating 30 VDC 3A.

WARNING: This product can expose you to chemicals including Dichloromethane, which is known to the State of California to cause cancer, and Bisphenol A (BPA) which is known to the State of California to cause birth defects or other reproductive harm. For more information go to www.P65Warnings.ca.gov.

INSTALLATION OF SS2xx0, 2xx1, 2xx3 and 2xx4 SERIES STOPPER®STATION

All specifications and information shown were current as of publication, and are subject to change without notice



TERMINAL BLOCK KIT-E10196 NO (1) PROVIDED
 KIT-E10198 NC (1) PROVIDED
 SEE VIEW IN DIRECTION OF ARROW
 FOR CONTACT IDENTIFIER LOCATIONS
 UP TO (3) TERMINALS MAY BE USED FOR EACH
 STATION ASSEMBLY.

SCREWS #6-32 x 1
 OUTLET BOX (2) PROVIDED.
 SCREWS #6-32 x 1.50 WHEN
 USING KIT-102720-“COLOUR” SPACER
 (SEE REVERSE SIDE).

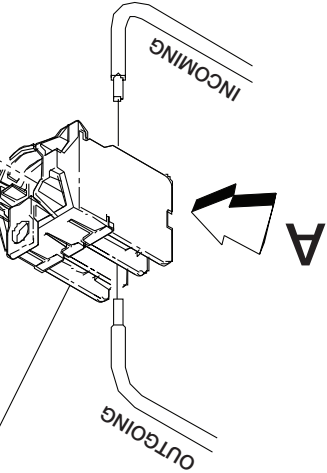
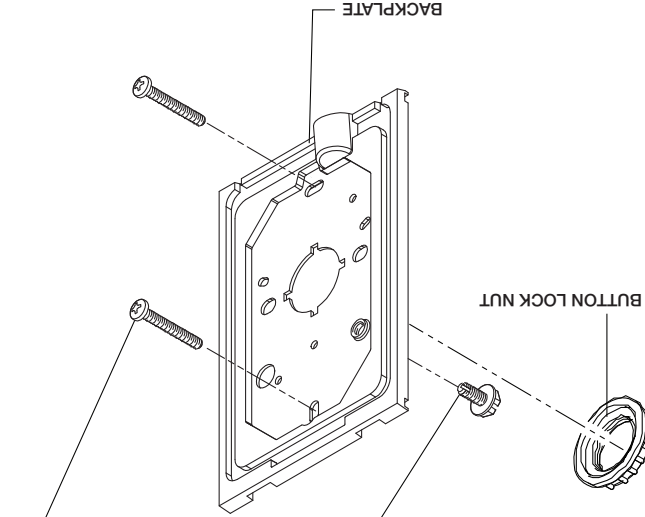

TERMINAL BLOCK
 RELEASE LEVER
 MUST FACE UPWARD
 AS SHOWN FOR SWITCH
 TO FUNCTION CORRECTLY.

ELECTRICAL TERMINAL BLOCK
 UP TO 3 TERMINALS MAY BE USED

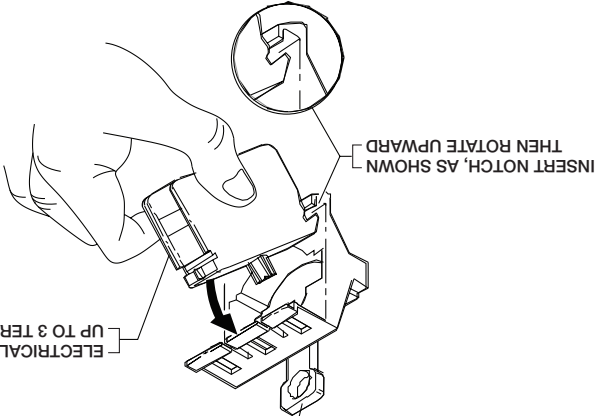

REMOVAL OF TERMINAL BLOCK
 FROM TERMINAL HOUSING: INSERT
 SMALL SCREWDRIVER (AS SHOWN)
 AND PRY UPWARD, REMOVE TERMINAL.

SEPARATION OF TERMINAL ASSEMBLY
 FROM BUTTON ASSEMBLY IS AS FOLLOWS:
 GRASP TERMINAL HOUSING AND USING THUMB
 APPLY PRESSURE DOWNWARD, REMOVE TERMINAL.

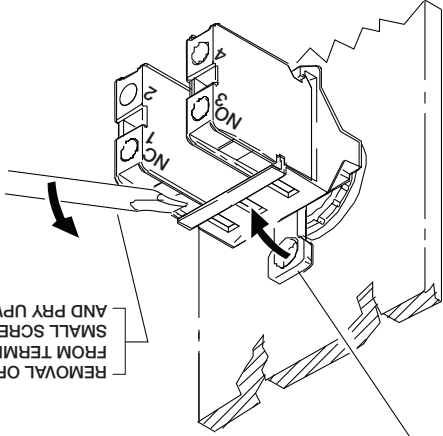
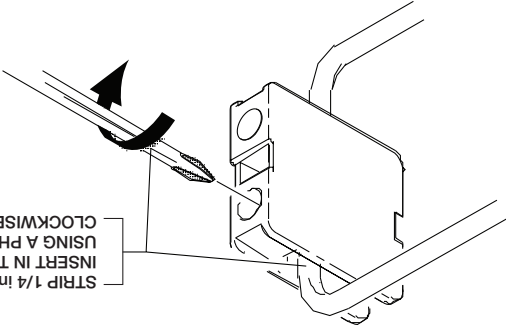

INSTALLATION OF SS2xx0, 2xx1, 2xx3 and 2xx4 SERIES STOPPER®STATION

All specifications and information shown were current as of publication, and are subject to change without notice

NOTE: SS2xx4/LT CONTACTS ON FORM C TIMER RATED: 120 VAC, 3A
 28 VDC, 3A

ALL TERMINALS ACCEPT TWO 12 TO 18 (AWG)	VOLTAGE RATED	600 VAC
	AVERAGE CURRENT	250 VDC
		3 AMP
		1 AMP