

## 8 MP (4K) IR Minidome IP Cameras

H4D8PR1

Honeywell is taking quality and reliability to the next level with the new Performance Series 4K Ultra HD rugged IP minidome cameras. The Honeywell TDN Ultra HD IR minidome cameras offer incomparable picture clarity, hassle-free flexible system integration, and secure data transmission—and they install easily too!

### Ultra HD 4K Image Quality

- Ultra HD 8 MP (4K) 15 fps image with a 1/2.5" 8 megapixel progressive scan CMOS, or full HD 3 MP 25/30 fps image
- Digital WDR (DWDR) ensures glare-free images
- True Day/Night provides vivid color images by day and clear black-and-white images at night with ICR
- Excellent low-light performance with 3D noise reduction, saving storage and bandwidth together with H.265 codec

### Flexible Surveillance Solution

- 4.0 mm, F1.6, fixed lens
- H.265, H.264 and MJPEG codec, triple stream support
- IR LEDs provide up to 30 m (100 ft.) of illumination in dimly lit or nighttime scenes (depending on scene reflectance)
- Smart IR technology provides even distribution of IR
- Waterproof (IP66) and IK10 impact-resistant camera housing
- -30°C to 60°C (-22°F to 140°F) working temperature
- Security features include individual signed certificates and data encryption
- Cameras can be retrofitted on many existing DVR/NVR installations without requiring additional storage

### Onboard Video Storage

- Supports up to 128 GB microSDHC card for local video storage on events, continuous, or schedule, or with network interruption



### Easy to Install and Use

- Built-in PoE (Power over Ethernet 802.3af) eliminates separate power supply and associated wiring; 12 VDC input where PoE power is unavailable
- ONVIF Profile S and G compliant
- Included accessories: security screw driver (allen key), mounting screws, wall anchors, and mounting template

### Market Opportunities

These fully featured attractive cameras are perfect for outdoor installations that require excellent picture quality at minimal bandwidth while offering maximum protection against dust, dirt, and water. Boasting a sleek modern design and offering 4K high definition images, the cameras are suited for a wide range of applications.

## FEATURES AND BENEFITS

- |  |  |   |  |   |
|--|--|---|--|---|
| • Ultra HD 4K/8 MP resolution at 15 fps or 3 MP at 25/30 fps | • 30 m (100 ft.) IR distance, depending on scene reflectance | • Excellent low light performance with down to 0 lux BW (with IR LEDs on) | • 4.0 mm, F1.6, fixed lens                           | • ONVIF profile S and G compliant   |
| • Up to triple stream support                                | • 1/2.5" 8 megapixel progressive scan CMOS imager            | • Choice of 12 VDC or PoE (802.3af) power inputs                          | • Corridor mode viewing capability                   | • Global language support with 12 languages for all QIGs, and 2 languages for the Web GUI |
| • Digital WDR  |  |   | • On board camera storage: up to 128 GB microSD card |   |

# 8 MP (4K Ultra HD) IR Minidome IP Cameras

## FEATURES CONTINUED

The camera can be configured to automatically detect and respond to events such as motion in the scene, alarm inputs, network failure, and/or camera tampering. Automated responses include: sending a notification through email and/or HTTP; sending a still image of the event through email and/or FTP; and recording a video clip of the event to a configured microSDHC card. Setup can be done through a web client.

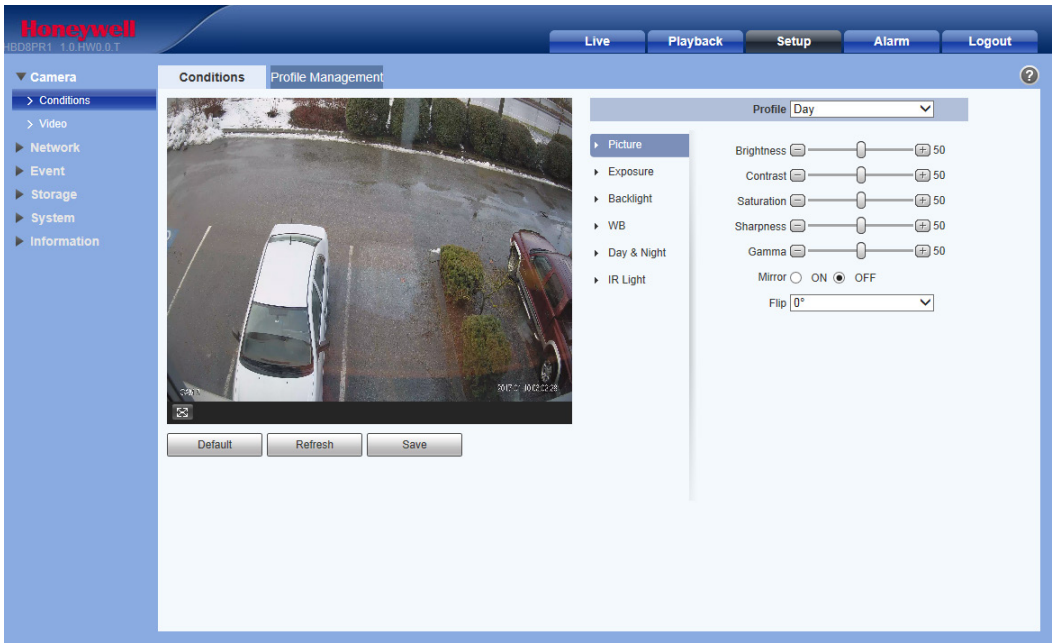

## DIMENSIONS

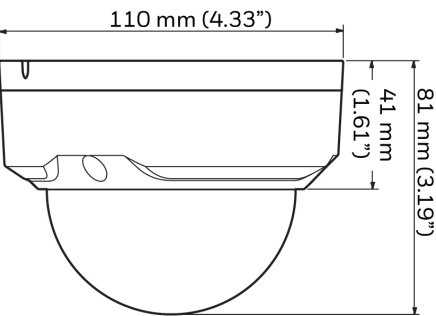

# 8 MP (4K Ultra HD) IR Minidome IP Cameras

## Technical Specifications

OPERATIONAL		
VIDEO STANDARD		NTSC/PAL
SCANNING SYSTEM		Progressive scan
IMAGE SENSOR		1/2.5" 8 MP Progressive CMOS
NUMBER OF PIXELS (H × V)		3840 × 2160
MINIMUM ILLUMINATION		0.1 lux (color)/0 lux (B/W) @ F1.6 (with IR LEDs on)
S/N RATIO		> 42 dB
ELECTRONIC SHUTTER SPEED		Auto, Manual, 1/3(4) – 1/100,000 sec
IR DISTANCE		Up to 100 ft. (30 m), depending on scene reflectance
DAY/NIGHT		Auto (ICR)/Color/BW
BACKLIGHT COMPENSATION		BLC/HLC/DWDR
WIDE DYNAMIC RANGE		Digital WDR (DWDR)
WHITE BALANCE		Auto/Manual/Natural/Street Lamp/Outdoor/Regional Custom
GAIN CONTROL		Auto/Manual
NOISE REDUCTION		3DNR
PRIVACY MASKING		Up to 4 areas
CORRIDOR MODE		Yes
LENS		4.0 mm, Fixed lens, F1.6
ANGLE OF VIEW		Horizontal: 88° Vertical: 48°
AUDIO/TWO-WAY		Line In/Out
ALARM INPUT/OUTPUT		1/1
ETHERNET		RJ-45 (10/100Base-T)
IP SPECIFICATIONS		
VIDEO COMPRESSION		H.265/H.264/MJPEG Bit rate control (CBR and VBR)
RESOLUTION	16:9	8M (3840×2160) / WQHD (2560×1440) / 3M (2304×1296) / 1080p (1920×1080) / 720p (1280×720)
	4:3	1.3M (1280×960)
	OTHER	6M (3072×2048) / 4M (2688×1520) / SXGA (1280×1024) / D1 (704×576/704×480) / CIF (352×288/352×240)
FRAME RATE	MAIN STREAM	8M (3840×2160) 1–15 fps; 6M (3072×2048) 1–20 fps; 4M (2688×1520) / WQHD (2560×1440) 1–25 fps; 3M (2304×1296) or lower resolution at 1–25/30 fps
	SECOND STREAM	D1/CIF up to 25/30 fps
	THIRD STREAM	720p/D1 up to 25/30 fps
AUDIO COMPRESSION		G.726/G.711a/G.711u/AAC
AUDIO STREAM		Full duplex, simplex

SUPPORTED PROTOCOLS*	IPv4/v6, TCP/IP, UDP, RTP, RTSP, HTTP, HTTPS, SSL, ICMP, FTP, SMTP, DHCP, PPPoE, UPnP, IGMP, SNMP, Bonjour, DNS, DDNS, IEEE 802.1x, QoS, NTP, IP Filter, Multicast, ONVIF
COMPATIBILITY	ONVIF Profile S and G
MAXIMUM USERS ACCESS	20 users
SUPPORTED WEB BROWSERS	Internet Explorer® (11.0+)
SUPPORTED OS	Windows® 7 32-bit/64-bit
SECURITY	Multiple user access levels with enhanced password policy, IP filtering, IEEE 802.1x, Strong Digest authentication for Access permission, Force to HTTPS with secure protocol TLS1.2 only and high strength encrypted algorithm AES-256, SSH/Telnet closed
MICRO SD	Up to 128 GB microSDHC card
MICRO SD FUNCTION	Event trigger recording Continuous and scheduled recording Automatic recording when network fails
LANGUAGES SUPPORTED	English, Japanese
ELECTRICAL	
POWER SUPPLY	PoE (802.3af) Class 0/12 VDC
POWER CONSUMPTION	6.7 W max. (IR LEDs on)
MECHANICAL	
DIMENSIONS	Ø110.0 mm × 81.0 mm (Ø4.3" × 3.2")
PRODUCT WEIGHT	0.406 kg (0.9 lb.)
PACKAGE WEIGHT	0.531 kg (1.2 lb.)
CONSTRUCTION COLOR	White (RAL CODE 9003)
ENVIRONMENTAL	
OPERATING TEMPERATURE	−30°C to 60°C (−22°F to 140°F)
RELATIVE HUMIDITY	Less than 95%, non-condensing
INGRESS PROTECTION	IP66
IMPACT RESISTANCE	IK10
REGULATORY	
EMISSIONS	FCC Part 15B, EN55032
IMMUNITY	EN50130-4, EN55024
SAFETY	EU: EN60950-1 North America UL listed to UL/CSA 60950-1
ROHS	EN50581: 2012

\* Some development may be required in specific user cases to support some of these protocols in the field as they mature over time.

# 8 MP (4K Ultra HD) IR Minidome IP Cameras

## RECOMMENDED ACCESSORIES

### SYSTEM INTEGRATION

ONVIF support and open API software integration. Refer to [www.onvif.org](http://www.onvif.org) for the ONVIF specification and the Honeywell Open Technology Alliance website (<http://www.security.honeywell.com/hota/>) to learn more about our open and integrated solutions.



### RECOMMENDED MOUNTS

HQA-BB2	Junction Box (Off-White)
HQA-WK	Wall Mount Bracket (Off-White)
HB34S2-CM	Corner Mount Adapter (Off-White)**
HQA-PM2	Pole Mount Adapter (Off-White)**

### RECOMMENDED RECORDERS

HEN081*4	8ch, 2 HDD, 8 PoE, 4K, H.265
HEN161*4	16ch, 2 HDD, 16 PoE, 4K, H.265
HEN321*4	32ch, 2 HDD, 16 PoE, 4K, H.265
HEN162*4	16ch, 4 HDD, 16 PoE, 4K, H.265
HEN322*4	32ch, 4 HDD, 16 PoE, 4K, H.265
HEN642*4	64ch, 4 HDD, 16 PoE, 4K, H.265
HEN163*4	16ch, 8 HDD, 16 PoE, 4K, H.265, RAID 5&6
HEN323*4	32ch, 8 HDD, 16 PoE, 4K, H.265, RAID 5&6
HEN643*4	64ch, 8 HDD, 16 PoE, 4K, H.265, RAID 5&6

\* The \* = hard drive capacity in TB.

\*\* With a compatible junction box (HQA-BB2).

## ORDERING

H4D8PR1	Network TDN Ultra 4K HD IR Rugged Dome Camera, 1/2.5" CMOS, 8 MP, 4.0 mm Fixed Lens, PoE, H.265
---------	---

### For more information

[www.honeywell.com/security/uk](http://www.honeywell.com/security/uk)

### Honeywell Security and Fire

Aston Fields Road  
Whitehouse Industrial Estate  
Runcorn  
Cheshire WA7 3DL  
Tel: 08448 000 235  
[www.honeywell.com](http://www.honeywell.com)

ONVIF and the ONVIF logo are trademarks of ONVIF Inc.  
Honeywell reserves the right, without notification, to make changes in product design or specifications.

HSFV-H4D8PR1-01-UK(0617)DS-R  
© 2017 Honeywell International Inc.

**Honeywell**

## H4D3PRV2/H4D3PRV3

### Performance Series IP 3 MP True Day/Night IR Rugged Indoor/Outdoor Mini Dome Camera

The H4D3PRV2 and H4D3PRV3 are affordable, fully featured IP cameras that pair perfectly with a 4/8/16-channel Performance Series Embedded NVR\*.

#### Superior Image Quality

- 3 MP (20 fps) and Full HD 1080p (25/30 fps) image with 1/3" 3 MP sensor, true widescreen image on a 16:9 display, 12.5% more horizontal pixel density than conventional 3 MP 4:3 (2048×1536) cameras
- True Day/Night capability, vivid colour pictures by day and clear black-and-white pictures at night with ICR
- Excellent low-light performance with 3D Noise Reduction, saving storage and bandwidth together with H.264 High Profile codec

#### Flexible Surveillance Solution

- IR LEDs provide up to 30 m (100 ft) of illumination in dimly lit or nighttime scenes
- Smart IR technology for even distribution of IR
- Waterproof (IP66) and IK10 vandal resistant camera housing
- Small form factor, inconspicuous after installation
- 2.7–12 mm F1.4 motorized focus/zoom lens (H4D3PRV2) and 2.8 mm F2.1 fixed lens (H4D3PRV3) provide wide range of field of view options
- Monitor from anywhere using HonView Touch mobile app for both Apple® and Android™ smart phones and tablet computers
- Configurable motion detection and camera tamper detection settings, including configurable alarm notifications

#### Easy to Install and Use

- Compact design, easy to hold with one hand during installation
- 3-axis rotation
- Built-in PoE (Power over Ethernet) eliminates separate power supply and associated wiring; 12 V DC inputs where PoE power is unavailable
- Plug-and-play with a Honeywell 4/8/16-channel Performance Series Embedded NVR
- Remote configuration, motorized zoom adjustments and auto focus (H4D3PRV2) through Honeywell Viewer web client or Embedded NVR

#### Onboard Video Storage

- H4D3PRV2: Supports up to 128 GB microSDHC (Class 10 recommended) card for local video storage when network is interrupted (card not included)

#### Market Opportunities

These fully featured IP cameras perfectly complement your Embedded IP NVR and are an excellent, cost-effective option for both indoor and outdoor surveillance applications, including retail stores, schools, colleges, hospitals, commercial sites, industrial parks, airports, gated entrances, loading docks, and driveways.



H4D3PRV2



H4D3PRV3



# H4D3PRV2/H4D3PRV3 Specifications

MODEL		H4D3PRV3	H4D3PRV2
CAMERA			
IMAGE SENSOR		1/3" 3 megapixel progressive scan CMOS	
EFFECTIVE PIXELS		2304 (H) × 1296 (V)	
ELECTRONIC SHUTTER SPEED		Auto/Manual, 1–1/100000 s	Auto/Manual, 1/3(4)–1/100000 s
MIN. ILLUMINATION		0.1 lux, F2.1 (Colour); 0 lux (IR LEDs on)	0.1 lux, F1.4 (Colour); 0 lux (IR LEDs on)
S/N RATIO		More than 50 dB	
CAMERA FEATURES			
IR DISTANCE		Up to 30 m (100 ft), depending on scene reflectance	
DAY/NIGHT		Auto (ICR)/Colour/BW	
BACKLIGHT COMPENSATION		BLC/HLC/DWDR	
WHITE BALANCE		Auto/Manual	
GAIN CONTROL		Auto/Manual	
NOISE REDUCTION		3D	
PRIVACY MASKING		Up to 4 areas	
LENS			
FOCAL LENGTH		2.8 mm	2.7–12 mm
MAX. APERTURE		F2.1	F1.4
FOCUS CONTROL		Fixed	Auto
HORIZONTAL ANGLE OF VIEW		92°	86°–28°
LENS TYPE		Fixed	Motorized focus/zoom
VIDEO			
COMPRESSION		H.264 (Main/High/Baseline Profile) /MJPEG	
RESOLUTION		3 MP (2304×1296), 1080p (1920×1080), 720p (1280×720), D1 (704×576/704×480), CIF (352×288/352×240)	
FRAME RATE	MAIN STREAM	3 MP (1–20 fps), 1080p (1–25/30 fps)	
	SUB STREAM	D1, CIF (1–25/30 fps)	
BIT RATE		H.264: 4–8192 kbps	
CORRIDOR MODE		Support	
NETWORK			
ETHERNET		RJ-45 (10/100Base-T)	
PROTOCOL		IPv4/IPv6, HTTP, HTTPS, TCP/IP, UDP, UPnP, ICMP, IGMP, RTSP, RTP, SMTP, NTP, DHCP, DNS, PPPoE, DDNS, FTP, IP Filter, QoS, 802.1X.	
COMPATIBILITY		ONVIF Profile S, Profile G - (H4D3PRV2 only).	
MAX. USER ACCESS		20 users	
MOBILE APP		HonView Touch for iPhone, iPad, Android Phone and Tablet	
GENERAL			
POWER SUPPLY		PoE (802.3af), 12 V DC	
POWER CONSUMPTION		4.7 W max. (IR LEDs on)	8.5 W max. (IR LEDs on)
WORKING ENVIRONMENT		–30°C to 60°C ( –22°F to 140°F); 10% to 100% RH, condensing	
INGRESS PROTECTION		IP66	
VANDAL RESISTANCE		IK10	
DIMENSIONS		110 × 81 mm (4.33 × 3.19 in.)	122 × 89 mm (4.8 × 3.5 in.)
WEIGHT		0.39 kg (0.86 lb)	0.5 kg (1.1 lb)
REGULATORY		FCC, Part 15B, Class B	

# H4D3PRV2/H4D3PRV3 Ordering

RECOMMENDED ACCESSORIES	
MOUNTS	
HQA-WK	Wall Mount for Dome and Ball Cameras
HQA-BB2	Junction Box
HB34S2-CM	Corner Mount (for use with HQA-BB2)
HQA-PM	Pole Mount (for use with HQA-BB2)

SYSTEM COMPATIBILITY	
HEN041**(X)	H.264 4-Channel 1080p Embedded Network Video Recorder (1 or 2 TB)*
HEN081**(X)	H.264 8-Channel 1080p Embedded Network Video Recorder (2, 4 or 6 TB)
HEN161**(X)	H.264 16-Channel 1080p Embedded Network Video Recorder (3 or 6 TB)

\* The 4 channel NVR models do not support 3MP cameras unless they are in 1080p mode

\*\* Denotes additional NVR model options

ORDERING	
HONEYWELL PERFORMANCE SERIES IP CAMERAS	
H4D3PRV2	Network TDN IR Rugged Indoor/Outdoor Mini Dome Camera, 1/3" CMOS, 3 MP, 2.7-12 mm MFZ, 2 IR LEDs, PoE, H.264
H4D3PRV3	Network TDN IR Rugged Indoor/Outdoor Mini Dome Camera, 1/3" CMOS, 3 MP, 2.8 mm Fixed, 24 IR LEDs, PoE, H.264

## DIMENSIONS

H4D3PRV2

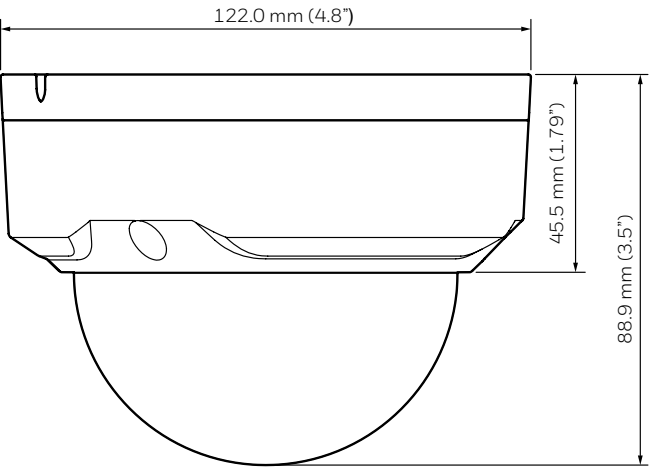

H4D3PRV3

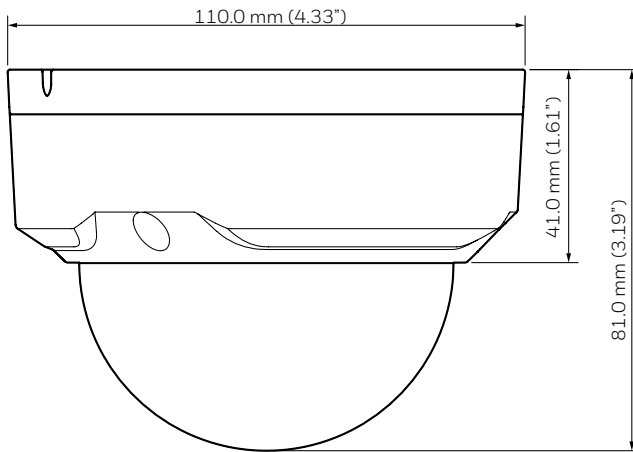

**Find out more:**

[www.security.honeywell.com/performance\\_uk](http://www.security.honeywell.com/performance_uk)

Email: [securitysales@honeywell.com](mailto:securitysales@honeywell.com)

**Honeywell Security and Fire**

Europe, Middle East and Africa

**United Kingdom**

Aston Fields Road

Whitehouse Industrial Estate

Runcorn

Cheshire

WA7 3DL

United Kingdom

Tel: +44 (0)8448 000 235

[www.honeywell.com/security/uk](http://www.honeywell.com/security/uk)

**Middle East**

Emaar Business Park, Sheikh Zayed Road

Building No. 2, 3rd Floor, Office No. 301

Post Office Box 232362

Dubai

United Arab Emirates

Tel: +971 44541704

[www.honeywell.com/security/me](http://www.honeywell.com/security/me)

**South Africa**

Honeywell House – Treur Close Waterfall Park

Gauteng

PO Box 6674

Midrand 1685

South Africa

Tel: +27 (0)11 695 8000

[www.honeywell.com/security/za](http://www.honeywell.com/security/za)

**Italy**

Via della Resistenza, 53/59

20090 Buccinasco

Milano

Italia

Tel: +39 (0) 248 880 51

[www.honeywell.com/security/it](http://www.honeywell.com/security/it)



## TDN WDR IR MFZ Mini Dome Camera

H4W2PRV2/H4W4PRV2

Honeywell's rugged H4W2PRV2/H4W4PRV2 mini dome cameras are taking quality and reliability to the next level, providing outstanding picture clarity and hassle-free flexible system integration.

### Superior Image Quality

- Full HD 1080p 25/30 fps image with a 1/2.7" 2 megapixel sensor or full HD 4 MP 20 fps image with a 1/3" 4 megapixel sensor
- Wide Dynamic Range, up to 120 dB, ensures glare-free images
- True Day/Night provides vivid color images by day and clear black-and-white images at night with ICR
- Excellent low-light performance with 3D noise reduction, saving storage and bandwidth

### Flexible Surveillance Solution

- 2.7–12 mm motorized focus/zoom lens at F1.4
- H.264 and MJPEG codec, triple stream support
- IR LEDs provide up to 100 ft (30 m) of illumination in dimly lit or nighttime scenes (depending on scene reflectance)
- Smart IR technology provides even distribution of IR
- Weatherproof (IP66) and vandal-resistant (IK10) camera housing
- -30°C to 60°C (-22°F to 140°F) working temperature
- Plug-and-play compatible with Honeywell 4/8/16-channel Performance Series Embedded NVRs

### Easy to Install and Use

- Built-in PoE (Power over Ethernet) eliminates need for separate power supply and associated wiring; 12 VDC inputs where PoE power is unavailable
- Remote configuration through web client or from the NVR
- Compatible with Honeywell's HQA-BB2 junction box, HQA-WK wall mount, HQA-PM pole mount, and HB34S2-CM corner mount



### Market Opportunities

These flexible, fully featured cameras are ideal for a wide range of surveillance applications, providing excellent picture quality at minimal bandwidth while offering reliable protection against dust, dirt, and water.

## FEATURES AND BENEFITS

- |  |  |  |   |
|--|--|--|---|
| <ul style="list-style-type: none"><li>• 1/2.7" 2 MP or 1/3" 4 MP progressive scan imager</li><li>• 2.7–12 mm MFZ lens</li><li>• True day/night (IR-cut filter)</li><li>• Wide dynamic range up to 120 dB</li></ul> | <ul style="list-style-type: none"><li>• Low-light performance down to 0.1 lux (color) or 0 lux with IR LEDs on</li><li>• Up to 100 ft (30 m) IR illumination, depending on scene reflectance</li></ul> | <ul style="list-style-type: none"><li>• H.264 Main Profile compression</li><li>• Triple stream support</li><li>• Supports up to 20 connections</li><li>• Corridor mode</li><li>• PoE, 12 VDC support</li></ul> | <ul style="list-style-type: none"><li>• Plug-and-play compatible with Honeywell Performance Series Embedded NVRs</li><li>• IP66 and IK10-rated rugged housing</li></ul> |
|--|--|--|---|

# TDN WDR IR MFZ Mini Dome Camera

## Security Features

The camera can be configured to automatically detect and respond to events such as motion in the scene and/or camera tampering. Automated responses include sending a notification through email, FTP, and/or HTTP, and sending a still image of the event through email and/or FTP. Setup can be done using the web client or from an NVR.

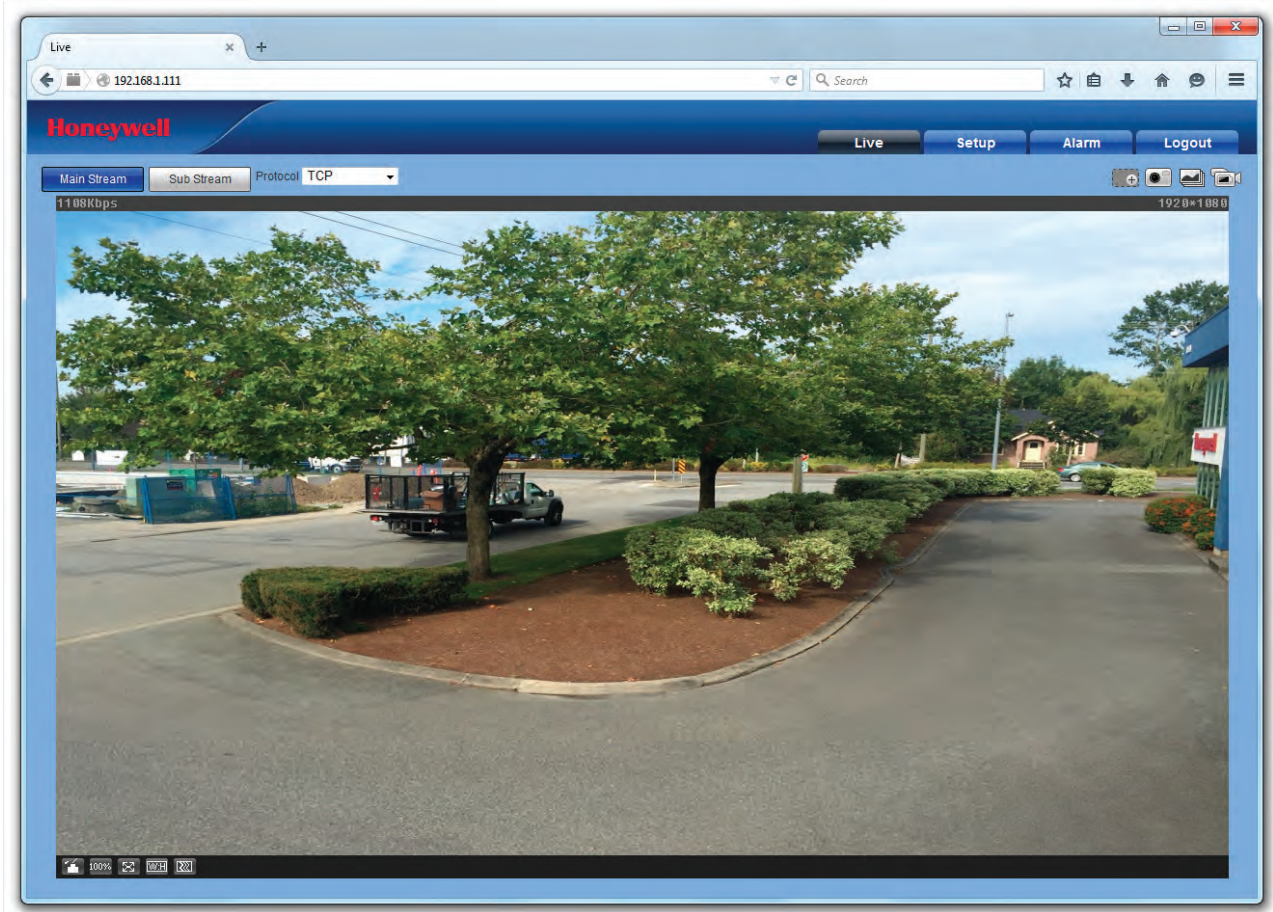

## DIMENSIONS

### H4W2PRV2/H4W4PRV2 Dimensions

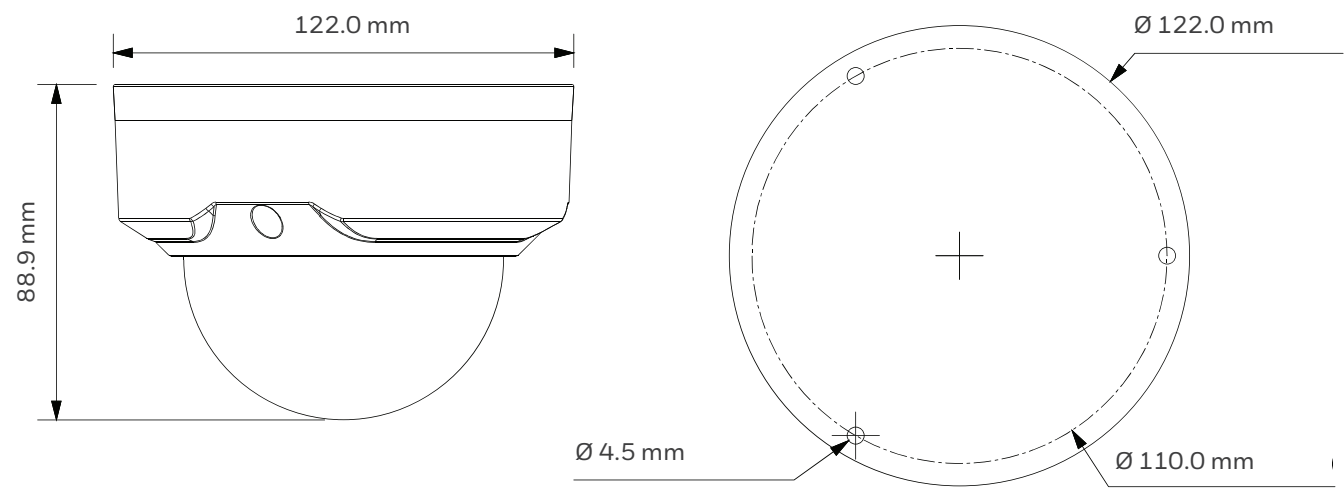

# TDN WDR IR MFZ Mini Dome Camera

## SPECIFICATIONS

OPERATIONAL	
VIDEO STANDARD	NTSC/PAL
SCANNING SYSTEM	Progressive scan
IMAGE SENSOR	H4W2PRV2: 1/2.7" 2 MP CMOS H4W4PRV2: 1/3" 4 MP CMOS
NUMBER OF PIXELS (H×V)	H4W2PRV2: 1920×1080 (2 MP) H4W4PRV2: 2688×1520 (4 MP)
MINIMUM ILLUMINATION	0.1 lux, F1.4 (color) 0 lux (B/W with IR LEDs on)
S/N RATIO	50 dB or more
ELECTRONIC SHUTTER SPEED	1/3–1/100 000 s
IR DISTANCE	Up to 100 ft (30 m), depending on scene reflectance
DAY/NIGHT	Auto(ICR)/Color/BW
BACKLIGHT COMPENSATION	BLC/HLC/WDR (120 dB)
WHITE BALANCE	Auto/Manual
GAIN CONTROL	Auto/Manual
NOISE REDUCTION	3DNR
PRIVACY MASKING	Up to 4 areas
MOTION DETECTION	Up to 4 areas
LENS	2.7–12 mm, MFZ, F1.4
HORIZONTAL ANGLE OF VIEW	H4W2PRV2: 93° - 35° H4W4PRV2: 86° - 30°
CORRIDOR MODE	Yes
VIDEO	
VIDEO COMPRESSION	H.264/H.264H/H.264B/ MJPEG
FRAME RATE	H4W2PRV2: 25/30 fps @ 1920 ×1080 (2 MP), 25/30fps @ 1280×1024 (SXGA), 25/30fps @ 1280×960 (1.3 MP), 1280×720 (720p), 704×576/704×480 (D1), 352×288/352×240 (CIF) H4W4PRV2: 20 fps @ 2688×1520 (4 MP); 20 fps @ 2560 × 1440 (4 MP); 25/30 fps @2304×1296 (3 MP), 1920×1080 (1080p), 25/30fps @ 1280×1024 (SXGA), 25/30fps @ 1280×960 (1.3 MP), 1280×720 (720p), 704×576/ 704×480 (D1), 352×288/352×240 (CIF)
BIT RATE (H.264)	32 Kbps – 10 Mbps
LOCAL STORAGE	microSD, 128 GB max. (not supplied)

NETWORK	
ETHERNET	RJ-45 (10/100Base-T)
PROTOCOLS*	IPv4/IPv6, HTTP, HTTPS, SSL, TCP/IP, UDP, UPnP, ICMP, IGMP, SNMP, RTSP, RTP, SMTP, NTP, DHCP, DNS, PPPoE, DDNS, FTP, IP Filter, QoS, Bonjour, 802.1X
COMPATIBILITY	ONVIF Profile S , Profile G*
MAX. USER ACCESS	20 users
MOBILE DEVICES	HonView Touch for iPhone and Android devices
ELECTRICAL	
POWER SUPPLY	PoE IEEE 802.3af Class 0, 12 VDC
POWER CONSUMPTION	8.0 W max.
MECHANICAL	
DIMENSIONS	122.0 × 88.9 mm (4.8 × 3.5 in.)
WEIGHT	1.1 lb (0.5 kg)
CONSTRUCTION	Die-cast aluminum housing with powder coat
CONSTRUCTION COLOR	RAL 9003 (White)
ENVIRONMENTAL	
TEMPERATURE	–30°C to 60°C (–22°F to 140°F)
RELATIVE HUMIDITY	0–95%, non-condensing
INGRESS PROTECTION	IP66
VANDAL RESISTANCE	IK10
REGULATORY	
EMISSIONS	FCC Part 15, CE (EN 55032)
IMMUNITY	CE (EN 50130-4)
SAFETY	North America UL Listed to UL/ CSA 60950-1, CE (EN 60950-1)

*\* Some development may be required in specific user cases to support some of these protocols in the field as they mature over time.*

# TDN WDR IR MFZ Mini Dome Camera

## SPECIFICATIONS

### SYSTEM INTEGRATION

#### OPEN IP INTEGRATION

ONVIF support and open API software integration. Refer to [www.onvif.org](http://www.onvif.org) for the ONVIF specification and the Honeywell Open Technology Alliance website (<http://www.security.honeywell.com/hota/>) to learn more about our open and integrated solutions



### SYSTEM COMPATIBILITY

#### NVRS

HEN041*2(X)	H.264 4-Channel 1080p Embedded Network Video Recorder
HEN081*2(X)	H.264 8-Channel 1080p Embedded Network Video Recorder
HEN161*2(X)	H.264 16-Channel 1080p Embedded Network Video Recorder

## ORDERING

### ACCESSORIES

#### MOUNTS

HQA-BB2	Junction box
HQA-WK	Wall mount
HQA-PM	Pole mount
HB34S2-CM	Corner mount

### CAMERAS

H4W2PRV2	Network TDN WDR IR Mini Dome Camera, 1/2.7" CMOS, 2 MP, 2.7–12 mm MFZ, 2 High Power IR LEDs, PoE, H.264
H4W4PRV2	Network TDN WDR IR Mini Dome Camera, 1/3" CMOS, 4 MP, 2.7–12 mm MFZ, 2 High Power IR LEDs, PoE, H.264

### For more information

[www.honeywell.com/security/uk](http://www.honeywell.com/security/uk)

### Honeywell Security and Fire

Aston Fields Road  
Whitehouse Industrial Estate  
Runcorn  
Cheshire  
WA7 3DL  
UK  
Tel: 08448 000 235  
Fax: +44 (0)1928 754 050  
[www.honeywell.com](http://www.honeywell.com)

Honeywell reserves the right, without notification, to make changes in product design or specifications.

HSFV-PerfR2-MFZMiniDome-01-UK(0117)DS-E  
January 2017  
© 2017 Honeywell International Inc.

**Honeywell**

## TDN WDR IR Mini Dome Camera

H4W4PRV3

Honeywell's rugged H4W4PRV3 mini dome camera is taking quality and reliability to the next level, offering outstanding picture clarity and hassle-free flexible system integration.

### Superior Image Quality

- Full HD 4 MP 20 fps image with a 1/3" 4 megapixel sensor
- Wide Dynamic Range, up to 120 dB, ensures glare-free images
- True Day/Night provides vivid color images by day and clear black-and-white images at night with ICR
- Excellent low-light performance with 3D noise reduction, saving storage and bandwidth

### Flexible Surveillance Solution

- 2.8 mm fixed lens at F2.0
- H.264 and MJPEG codec, triple stream support
- IR LEDs provide up to 98 ft (30 m) of illumination in dimly lit or nighttime scenes (depending on scene reflectance)
- Smart IR technology provides even distribution of IR
- Weatherproof (IP66) and vandal-resistant (IK10) camera housing
- -30°C to 60°C (-22°F to 140°F) working temperature
- Plug-and-play compatible with Honeywell 4/8/16-channel Performance Series Embedded NVRs

### Easy to Install and Use

- Built-in PoE (Power over Ethernet) eliminates need for separate power supply and associated wiring; 12 VDC inputs where PoE power is unavailable
- Remote configuration through web client or from the NVR
- Compatible with HQA-BB2 junction box, HQA-WK wall mount, HQA-PM pole mount, and HB34S2-CM corner mount



### Market Opportunities

These flexible, fully featured cameras are ideal for a wide range of surveillance applications, providing excellent picture quality at minimal bandwidth while offering reliable protection against dust, dirt, and water.

## FEATURES AND BENEFITS

- |                                     |   |                                   |  |
|-------------------------------------|---|-----------------------------------|--|
| • 1/3" 4 MP progressive scan imager | • Low-light performance down to 0.01 lux (color) or 0 lux with IR LEDs on | • Triple stream support           | • Plug-and-play compatible with Honeywell Performance Series Embedded NVRs |
| • 2.8 mm fixed lens                 | • Up to 100 ft (30 m) IR illumination, depending on scene reflectance     | • Up to 4 MP resolution at 20 fps | • IP66 and IK10-rated rugged housing                                       |
| • True day/night (IR-cut filter)    | • H.264 Main Profile compression  | • Supports up to 20 connections   |  |
| • Wide dynamic range up to 120 dB   |   | • Corridor mode                   |  |
|                                     |   | • PoE, 12 VDC support             |  |



# TDN WDR IR Mini Dome Camera

## Security Features

The camera can be configured to automatically detect and respond to events such as motion in the scene and/or camera tampering. Automated responses include sending a notification through email, FTP, and/or HTTP, and sending a still image of the event through email and/or FTP. Setup can be done using the web client or from an NVR.

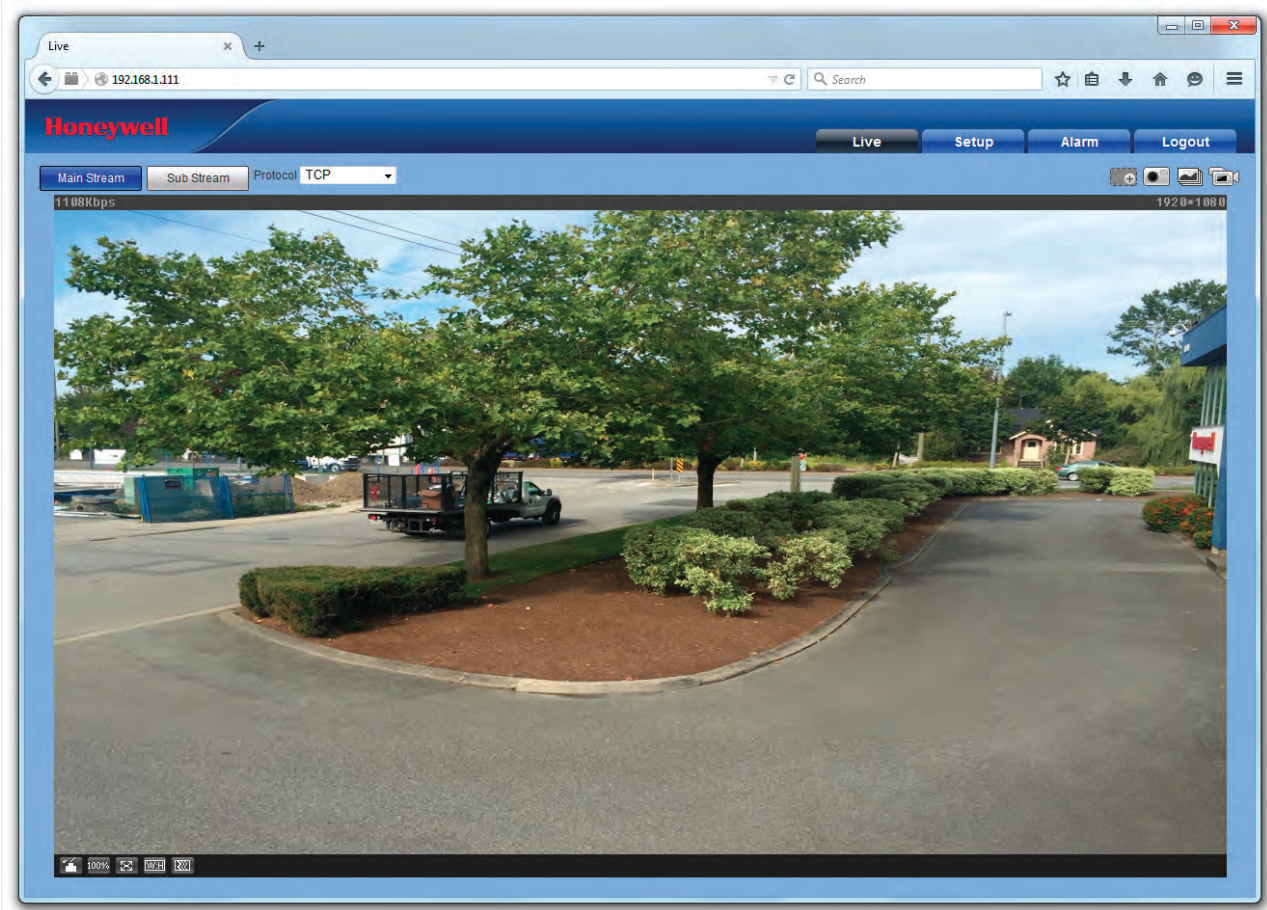

## DIMENSIONS

### H4W4PRV3

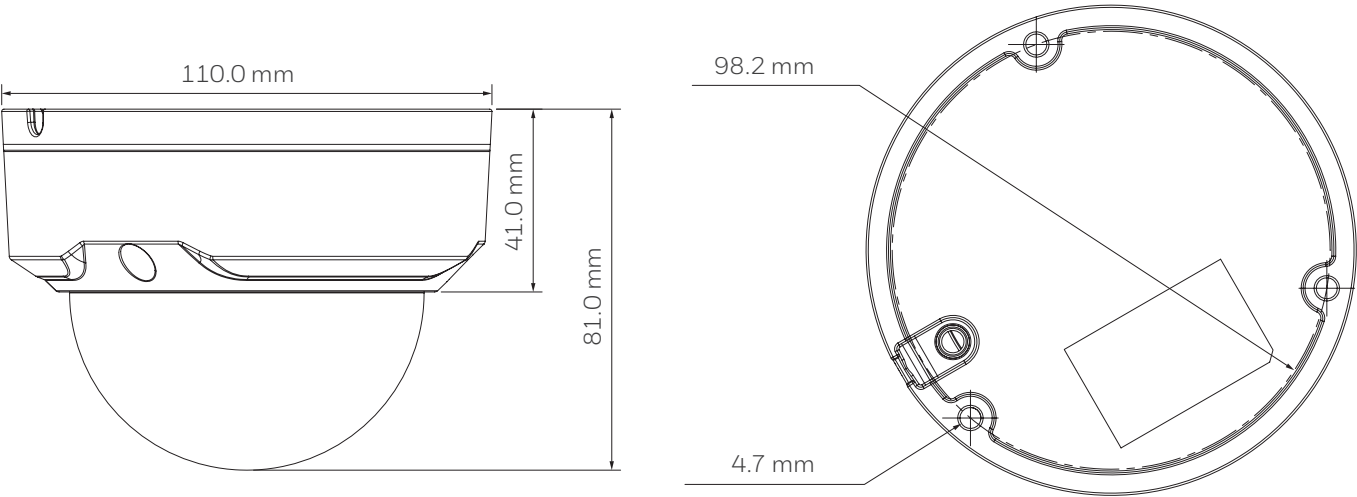

# TDN WDR IR Mini Dome Camera

## SPECIFICATIONS

OPERATIONAL		
VIDEO STANDARD		NTSC/PAL
SCANNING SYSTEM		Progressive scan
IMAGE SENSOR		1/3" 4 MP CMOS
NUMBER OF PIXELS (H×V)		2688×1520
MINIMUM ILLUMINATION		0.01 lux, F2.0 (color) 0 lux (with IR LEDs on)
S/N RATIO		50 dB or more
ELECTRONIC SHUTTER SPEED		Auto, Manual, 1/3–1/100 000 s
IR DISTANCE		Up to 98 ft (30 m), depending on scene reflectance
DAY/NIGHT		Auto(ICR)/Color/BW
BACKLIGHT COMPENSATION		BLC/HLC/WDR (120 dB)
WHITE BALANCE		Auto/Sunny/Night/Outdoor/ Customized
GAIN CONTROL		Auto/Manual
NOISE REDUCTION		3DNR
PRIVACY MASKING		Up to 4 areas
LENS		2.8 mm, F2.0
HORIZONTAL ANGLE OF VIEW		106°
CORRIDOR MODE		Yes
VIDEO		
VIDEO COMPRESSION		H.264/H.264H/H.264B/MJPEG
RESOLUTION		4 MP (2688×1520/2560×1440)/ 3 MP (2304×1296)/1080p (1920×1080)/720p (1280× 720)/D1(704×576/704×480)/ CIF(352×288/352×240)
FRAME RATE	MAIN STREAM	4 MP (1–20 fps)/ 3MP (1–25/30 fps)
	SUB STREAM	D1/CIF (1–25/30 fps)
	TRIPLE STREAM	720p (1–20 fps)
BIT RATE (H.264)		32 Kbps–10 Mbps

NETWORK	
ETHERNET	RJ-45 (10/100Base-T)
PROTOCOLS*	IPv4/IPv6, HTTP, HTTPS, SSL, TCP/ IP, UDP, UPnP, ICMP, IGMP, SNMP, RTSP, RTP, SMTP, NTP, DHCP, DNS, PPPoE, DDNS, FTP, IP Filter, QoS, Bonjour, 802.1X
COMPATIBILITY	ONVIF Profile S
MAX. USER ACCESS	20 users
MOBILE DEVICES	iPhone, iPad, Android
ELECTRICAL	
POWER SUPPLY	PoE (802.3af), 12 VDC
POWER CONSUMPTION	4.0 W max.
MECHANICAL	
DIMENSIONS	110.0 × 81.0 mm (4.33 × 3.19 in.)
PRODUCT WEIGHT	0.73 lb (0.33 kg)
PACKAGE WEIGHT	1.04 lb (0.47 kg)
CONSTRUCTION	Die-cast aluminum housing with powder coat
CONSTRUCTION COLOR	RAL 9003 (White)
ENVIRONMENTAL	
TEMPERATURE	–30°C to 60°C (–22°F to 140°F)
RELATIVE HUMIDITY	0–95%, non-condensing
INGRESS PROTECTION	IP66
VANDAL RESISTANCE	IK10
REGULATORY	
EMISSIONS	FCC Part 15, CE (EN 55032)
IMMUNITY	CE (EN 50130-4)
SAFETY	North America UL Listed to UL/CSA 60950-1, CE (EN 60950-1) North America UL Listed to UL/CSA 60950-22, CE (EN 60950-22)

*\* Some development  
may be required in  
specific user cases  
to support some  
of these protocols  
in the field as they  
mature over time.*

# TDN WDR IR Mini Dome Camera

## SPECIFICATIONS

---

### SYSTEM INTEGRATION

#### OPEN IP INTEGRATION

ONVIF support and open API software integration. Refer to [www.onvif.org](http://www.onvif.org) for the ONVIF specification and the Honeywell Open Technology Alliance website (<http://www.security.honeywell.com/hota/>) to learn more about our open and integrated solutions.



## ORDERING

---

### ACCESSORIES

#### MOUNTS

HQA-BB2	Junction box
HQA-WK	Wall mount
HQA-PM	Pole mount (requires HQA-BB2)
HB34S2-CM	Corner mount (requires HQA-BB2)

#### CAMERAS

H4W4PRV3	Network TDN WDR IR Mini Dome Camera, 1/3" CMOS, 4 MP, 2.8 mm Fixed, 24 IR LEDs, PoE, H.264
----------	--

### For more information

[www.honeywell.com/security/uk](http://www.honeywell.com/security/uk)

### Honeywell Security and Fire

Aston Fields Road  
Whitehouse Industrial Estate  
Runcorn  
Cheshire  
WA7 3DL  
UK  
Tel: 08448 000 235  
Fax: +44 (0)1928 754 050  
[www.honeywell.com](http://www.honeywell.com)

Honeywell reserves the right, without notification, to make changes in product design or specifications.

HSFV-PerfR2-MiniDome-01-UK(0117)DS-E  
January 2017  
© 2017 Honeywell International Inc.

**Honeywell**