

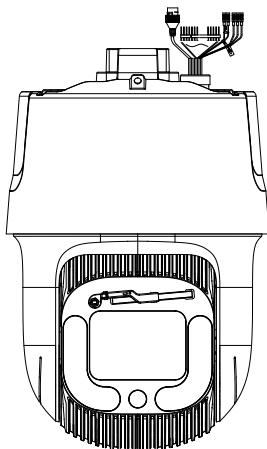

# Network Speed Dome

Quick Start Guide

1



2

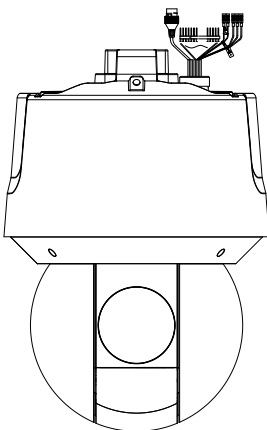

3

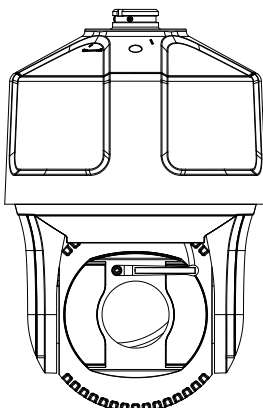

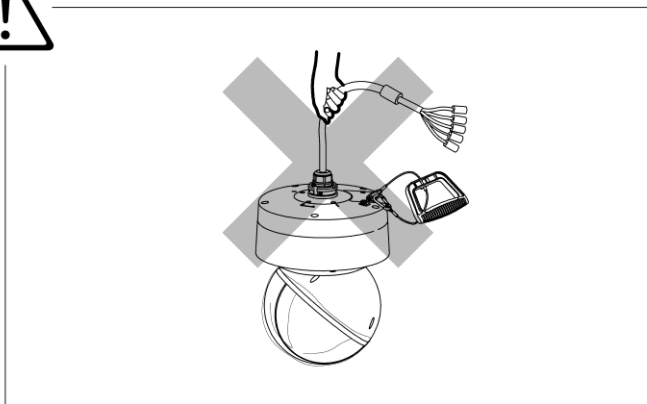
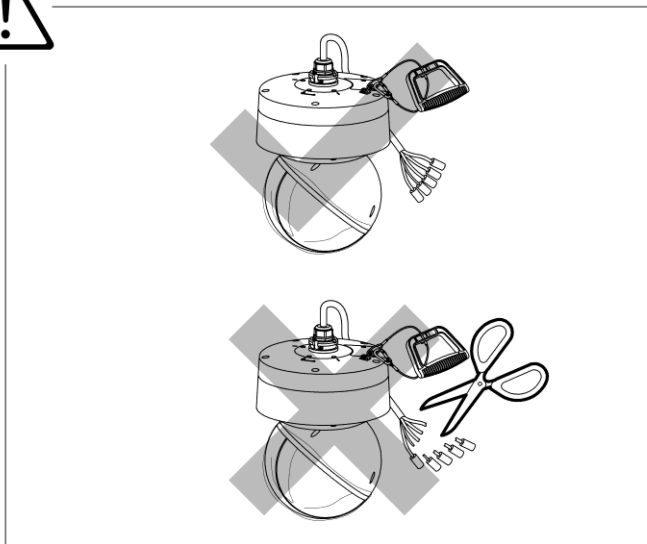

A

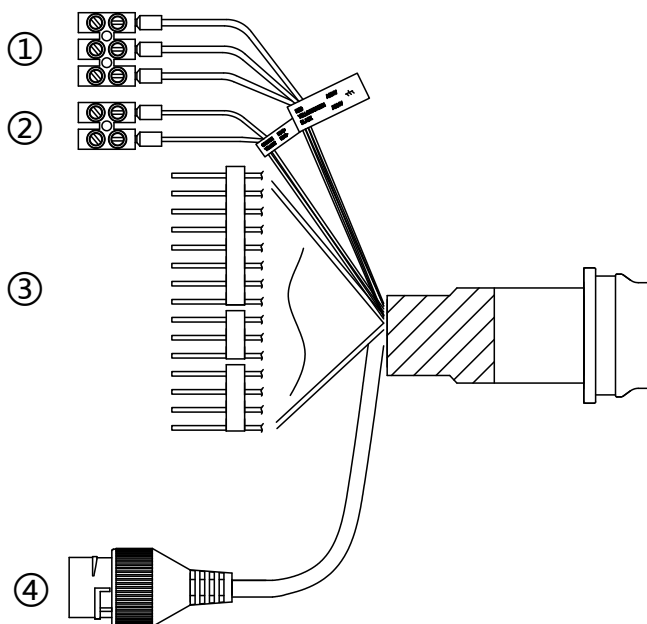

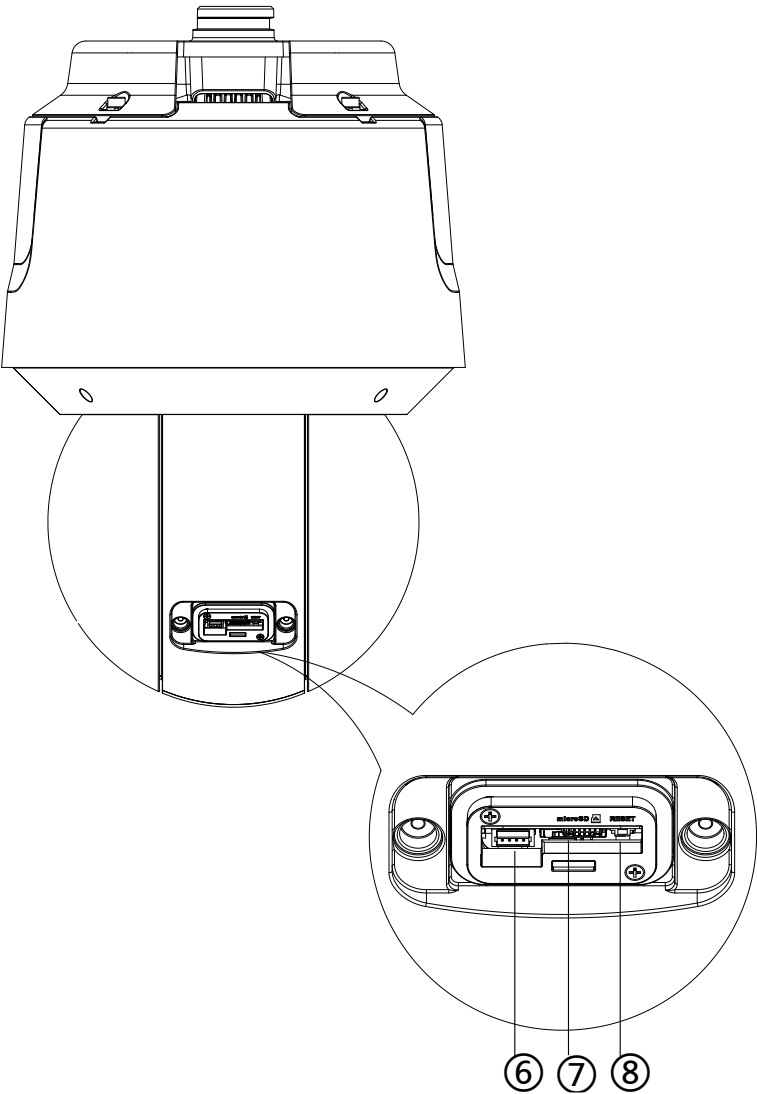

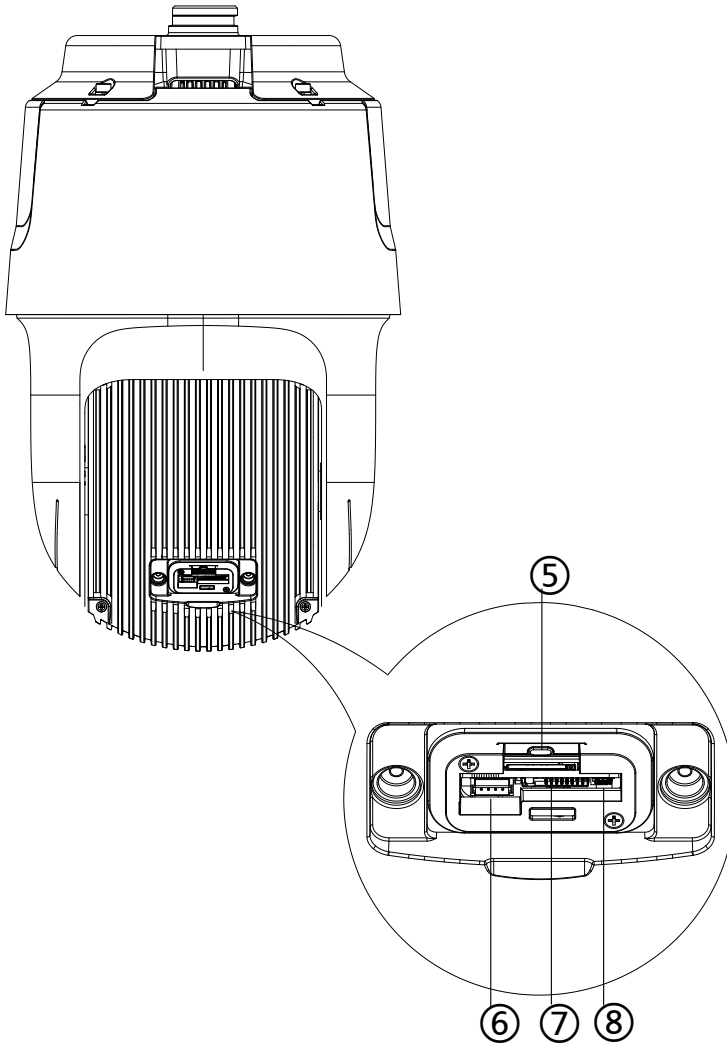

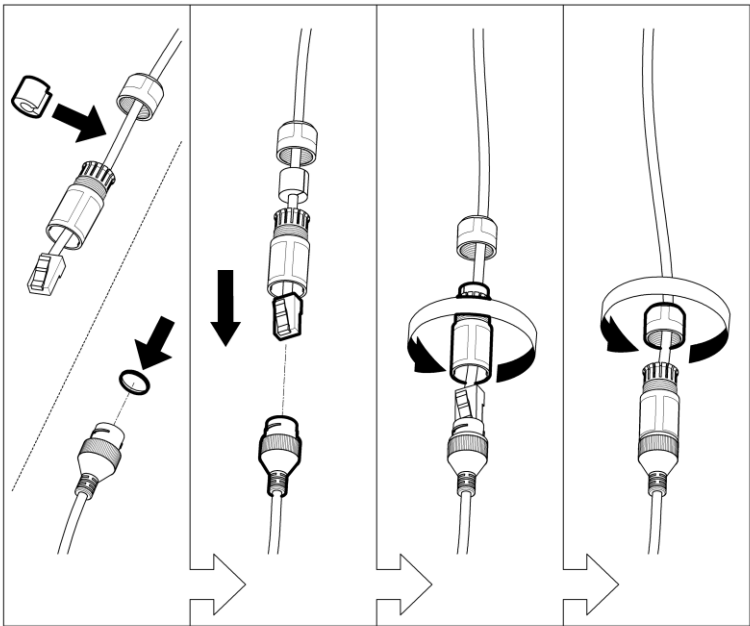
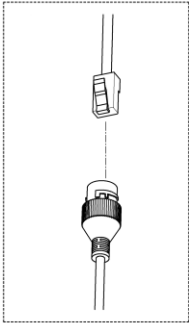

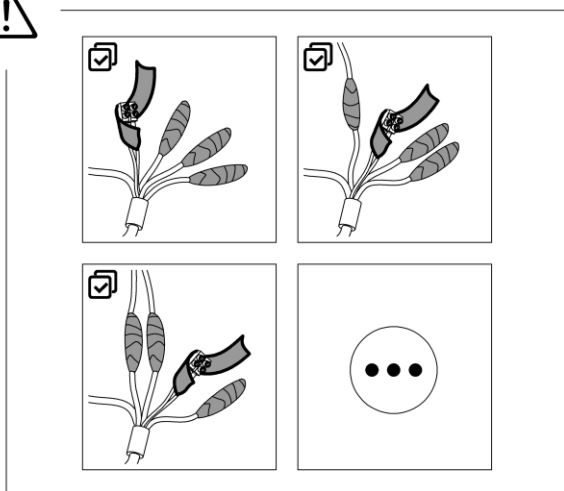
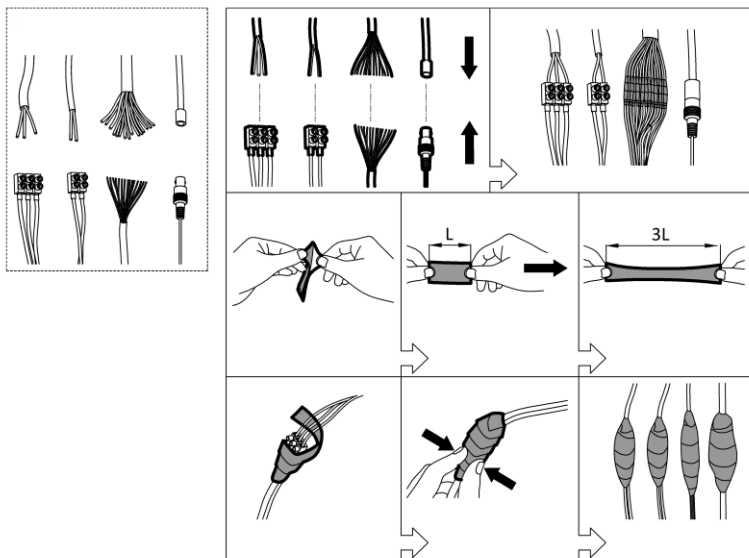



**B**

1

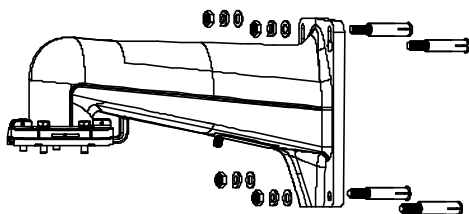

2

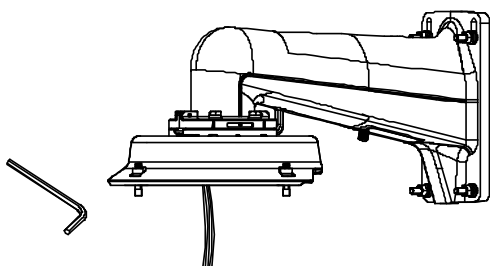

3

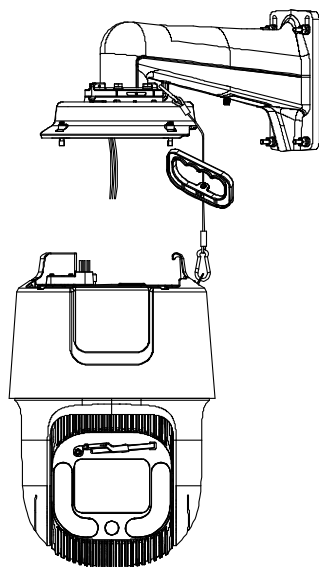

4

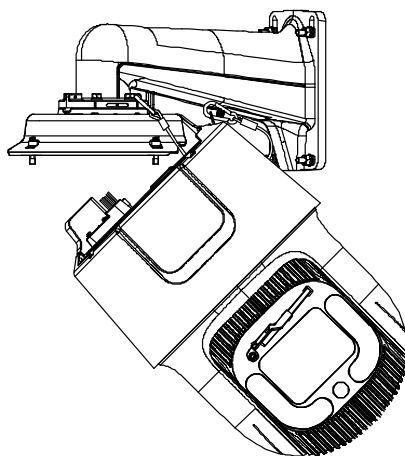

5

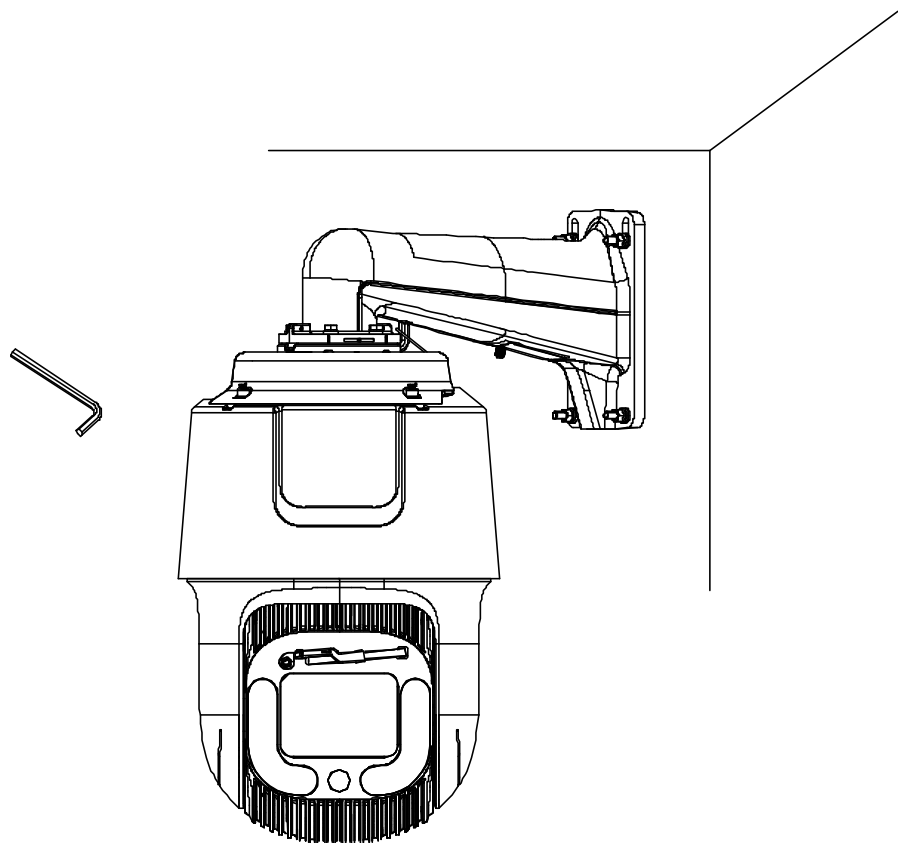

 Read this manual before using the product.

Product appearance is for reference only and may differ from the actual product.

## Interface (Page3 - A)

- ① Power interface
- ② RS-485 interface
- ③ Audio interface/Alarm interface
- ④ Network interface
- ⑤ SIM card
- ⑥ Serial port
- ⑦ Memory card slot
- ⑧ Reset button: Press reset button for about 10 s when the camera is powering on or rebooting to restore the default settings, including the user name, password, IP address, port No., etc.

**Note:** The interface varies with the models. Please refer to the product datasheet for details.

## Installation (Page8 - B)

### Steps:

1. Install the bracket.
  - 1) Drill four screw holes in the wall according to the holes on the bracket, and then insert four expansion screws into the mounting holes.
  - 2) Attach the gasket and the bracket to the wall by aligning the four screw holes on the bracket with four expansion screws on the wall.
  - 3) Secure the bracket with four hex nuts and washers.
2. Install the device cover on the bracket, and secure the screws on the bracket.
3. Hook the two ends of the safety rope to the speed dome and the bracket respectively.
4. Connect the cables and secure the device to the bracket.

## Alarm Output

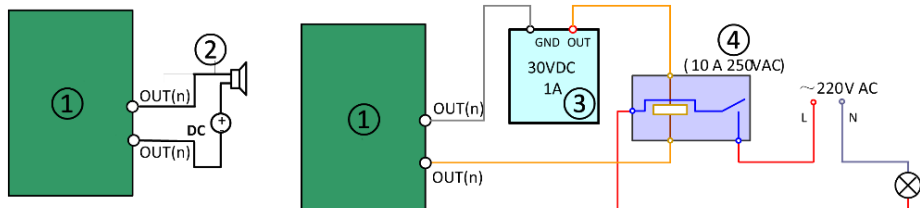

- ① Relay output
- ② DC load
- ③ Power supply
- ④ JQC-3FG Relay



**Protective Measures for Outdoor Installation**



**Activate and Access Network Camera**

