

Magnetic Locks and Bolts

Direct-Pull Magnet - Armlock 281

The Adams Rite Door magnet range are surface mounted direct pull magnets that are used as part of an access control system for electric locking applications.



Key Benefits

- Suitable for use on aluminium, timber and steel doors
- Compact case size and clean aesthetics
- Magnetic holding force of at least 510kg (1120 lbs)
- Has a security pin feature to help prevent unauthorised removal of the magnet from the door frame fixing plate
- Offers durability and low maintenance
- Available as a double magnet model
- User selectable dual voltage - 12 or 24vDC
- CE marked to EMC Directive
- Monitoring available (Hall Effect)
- Built in voltage spike suppressor
- Guarantee 3 years

Related Hardware

'L' and 'Z' Brackets ~ 4591M & 999M Monitored Paddle Handle & Exit Device
Switching Accessories ~ RiteKey Keypad ~ Push-to-Exit Button ~ Power Supply Unit

Magnetic Locks and Bolts

Direct-Pull Magnet - Armlock 281

Specification

Armlock 281-005

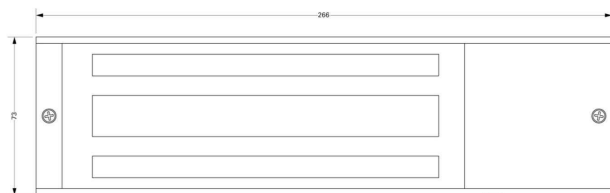

Armature for Armlock 280 Series magnets

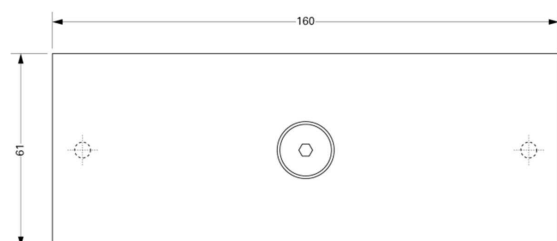

Single Magnet:	40mm x 266mm x 73mm.
Double Magnet:	40mm x 532mm x 73mm.
Armature:	16mm x 160mm x 61mm. (2 no. for double magnet)
Nominal Holding Force:	510kg (1120lbs).
Supply Voltage:	12 or 24vDC ($\pm 15\%$).
Nominal Current:	480mA @ 12vDC, 240mA @ 24vDC. Dual coil. Built-in voltage spike suppressor.
Monitoring:	Relay dry contact with LED.
Door Gap:	Maximum 3mm (1/8").
Positioning:	Outward opening - surface mounted to door frame header. Inward opening - door frame header using 'L' & 'Z' brackets
Magnet Housing:	Brushed satin aluminium.
Note:	To achieve immediate release, it is important that the release switch breaks the circuit on the positive supply to the magnet.

Ordering Information

281-000	281 STANDARD MAGNET SINGLE NON MONIOTORED
281-005	281 STANDARD MAGNET SINGLE MONITORED
281-200	281 STANDARD MAGNET DOUBLE NON MONITORED
281-205	281 STANDARD MAGNET DOUBLE MONITORED

'L' & 'Z' Brackets & 'L' & 'Z' Brackets with Cover Plates

Adams Rite have a variety of brackets and housings which can be used with our Direct Pull Magnets



Key Benefits

- Adjustable 'L' bracket: Suits typical outward opening door applications where there is not sufficient space to fit the magnet to the head of the door frame
- Suitable for use on aluminium, timber and steel doors
- 'L' & 'Z' Brackets: For conversion of Armlock r 280 Series magnets to inward opening door applications, the 'L' & 'Z' bracket kit consists of a standard 'L' bracket and two separate fully-adjustable plates which form the 'Z' bracket

Related Hardware

Armlock® 281

Specification

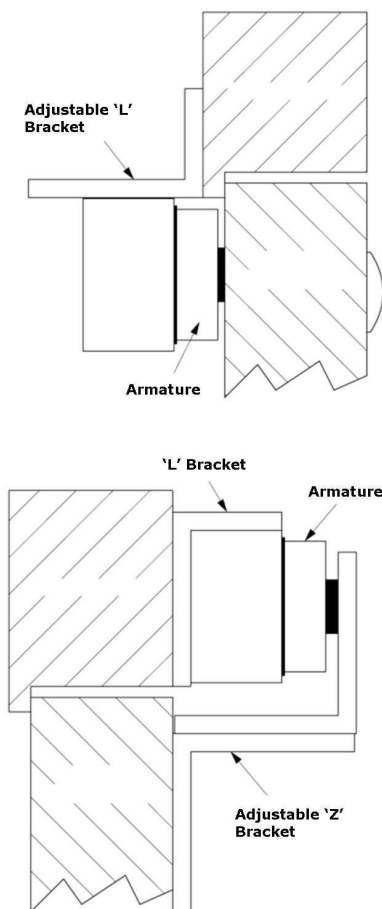

'L' & 'Z' Brackets

Adjustable 'L' Bracket:

Dimensions:	38mm x 266mm x 75.5mm.
Material:	Aluminium.

'L' & 'Z' Brackets:

Dimensions:	46mm x 266mm x 76mm (Adjustable and standard 'L' brackets). 63.5mm x 160mm x 63.5mm (Adjustable brackets).
Material:	Aluminium.

Rim Armature Housing:

Dimensions:	76mm x 175mm x 15mm.
Material:	Aluminium.

'L' & 'Z' Brackets with Cover Plates

Adjustable 'L' Brackets with cover Plates:

Dimensions:	39mm x 270mm x 64mm.
Material:	Aluminium.

'L' & 'Z' Brackets with Cover plate:

Material:	Aluminium.
-----------	------------

Rim Armature Housing:

Dimensions:	76mm x 175mm x 15mm.
Material:	Aluminium.

Ordering Information

281-700	'L' & 'Z' Brackets for Armlock 281 - Adjustable 'L' bracket, SAA finish
281-701	ADJUSTABLE L BRACKET FOR 281 MAGNET C/W COVER
281-800	'L' & 'Z' Brackets for Armlock 281 - 'L' & 'Z' bracket kit, SAA finish
281-801	L AND Z BRACKET FOR 281 MAGNET C/W COVER
281-900	'L' & 'Z' Brackets for Armlock 281 - Rim armature housings, SAA finish

Accessories

268-600	260/280 GLASS ARMATURE BRACKET
---------	--------------------------------

Magnetic Locks and Bolts

External Magnet - Armlock 291

The Adams Rite Door magnet range are surface mounted direct pull magnets that are used as part of an access control system for electric locking applications.



To facilitate remote access and exit control of any external gate/barrier.

Key Benefits

- Maintains a magnetic holding force of at least 540kg (1190lbs)
- Offers durability and low maintenance
- Compact case size and clean aesthetic
- Independently tested to achieve an ingress protection rating of IP67
- Built in voltage spike suppressor
- User selectable dual voltage - 12 or 24vDC
- Reed switches monitoring as standard
- Dual fixing positions to suit both side and face fix applications
- Suitable for use on aluminium, timber and steel doors
- Guarantee 3 years

Related Hardware

RiteKey Keypad ~ Power Supply Unit