



VIP Series Quick Guide

IP Bullet & Box Camera Range



Before You Begin

Please read this guide before installing or operating the product. You must have knowledge of CCTV, IT and electrical wiring and products.

Technical Support

If you still have questions after referring to the guide, or require more information, please contact Vista Technical Support or use the QR code.

Vista Technical Support +44 (0) 118 912 5125

**Norbain SD, Inspired, Easthampstead Road,
Bracknell, Berkshire RG12 1YQ**



* WARNING: Improper use can cause severe bodily injury or equipment damage.

This guide is intended for multiple product models. Illustrations and descriptions, etc may vary from actual appearance.

Bullet VIP-B2MP27V135IRAUAL
 VIP-B5MP28V12IRM
 VIP-B5MP27V135IRAUAL
 VIP-B8MP28V12IRAUAL



Bullet VIP-B5MP28IRM
 VIP-B8MP28IRM
 VIP-B5MP28IRWLM
 VIP-B8MP28IRWLM



Box VIP-X2MPAUAL



1. Packing List

Please contact Norbain if any items are missing or damaged and note contents will vary according to each camera model number.

- Camera
- Waterproofing items*¹
- Fixing Screws*²
- Template*³
- This guide

*¹ Including waterproofing components such as tape and sealing grommets.

*² Fixing screws and/or hex key according to camera model and requirement

*³ Drilling template (except VIP-X2MPAUAL box camera)

2. Safety & Maintenance Instructions

- Use only correctly rated PSU/PoE delivery devices meeting requirements shown in section titled **4. Power-up and Access Camera**.
- Keep lens cover in place until installation completed - prevent damage.
- Ensure Ethernet/power cable lengths are within specification for correct operation to avoid power or data loss.
- Ensure wall, ceiling and fixings are adequate to support the weight of the camera and any bracket.
- Remove dust from the lens gently using oil-free brush or blower.
- Do not use organic solvents (benzene\alcohol) to clean bubbles etc.
- Where waterproofing accessories are provided, please ensure they are fitted and in the correct order. Also fit weather plugs to unused DC power sockets (below)

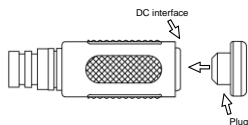
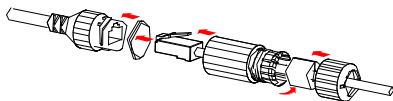

3. Drilling and Mounting - All Cameras

Common to all cameras (except VIP-X2MPAUAL box camera) is the template and drilling procedure. The square 4-hole template is shown below as an example.

1. Hold supplied template to ceiling or wall and drill 6mm to 6.5mm diameter holes to 30-mm depth.

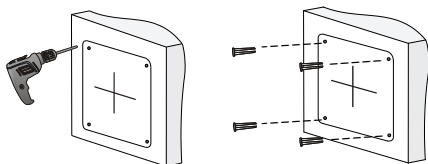

2. Drill hole for fly lead cable to pass through.
3. Insert plastic anchors.

Now refer to the section for your specific camera model number.

VIP-B2MP27V135IRAUAL
VIP-B5MP27V135IRAUAL
VIP-B8MP28V12IRAUAL
VIP-B5MP28V12IRM

Appearance and cable identification may vary between each model.

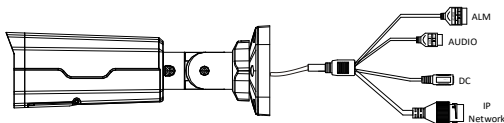

1. Alarm In\Out (excludes VIP-B5MP28V12IRM)	2. Audio
3. Power (12 VDC)	4. Ethernet PoE interface

(Optional) Insert Micro SD Card

Insert SD card into slot for local storage function (1) unscrew and remove cover (right). (2) Insert card (below) then refit cover.

Hot plugging is not recommended. Power first!

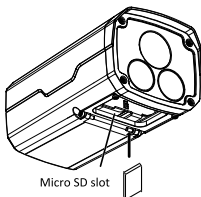
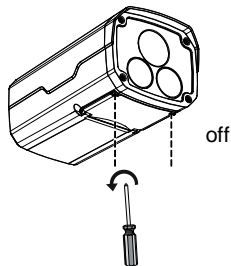

1. Loosen lock screw on camera bracket, connect required cables, pass cables through cable clearance hole and fix camera to wall or ceiling.

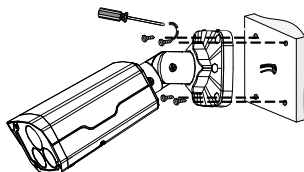
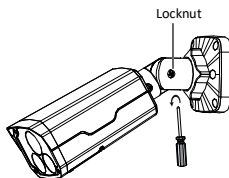

2. Adjust camera direction, rotation and elevation (below) as required;
 - i. Slacken additional lock screw (1) at rear of camera.
 - ii. Slacken large locking collar (3) at the base.

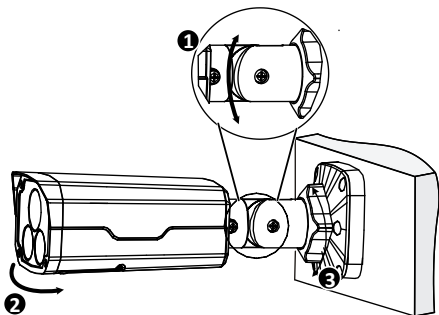

3. Once correct position and field of view is achieved, tighten both lock screws and large locking collar (3).

Note: Do not adjust camera direction by force with screw fully tightened! Loosen the screw first.

Now refer to section titled **4. Power-up and Access Camera**

VIP-B5MP28IRM

VIP-B5MP28IRWLM

VIP-B8MP28IRM

VIP-B8MP28IRWLM

Appearance and cable identification may vary between each model. For example, your chosen model may, or may not, have alarm in/out. Please refer to the individual camera datasheet.

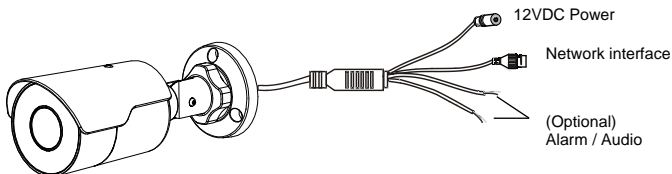

(Optional) Insert Micro SD Card

For cameras supporting Micro SD, insert card after opening the bottom cover of camera. Do not hot plug SD cards - power-down first!

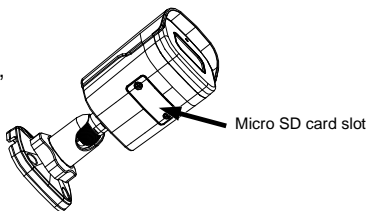

1. Loosen large locking nut before fixing camera to wall\ceiling – shown right.

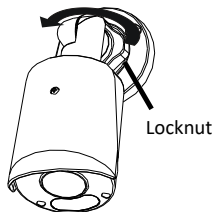

2. Pass cables through cable clearance hole, connect and fix camera to wall\ceiling (below). Use waterproof tape if provided.

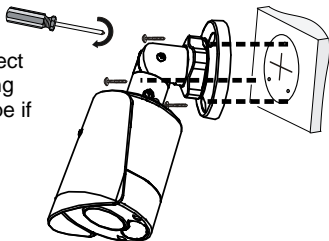

3. Adjust camera position, rotation and elevation of view as required (below), then lock into position by tightening.
- i. 2-lock screws (rear of camera & bracket elbow)
 - ii. Large locknut on camera base

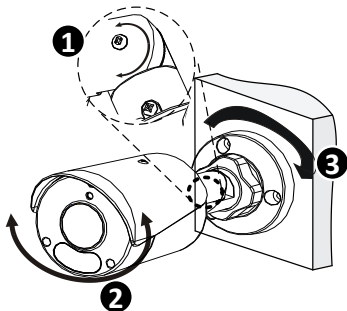

Now refer to section titled **4. Power-up and Access Camera**

VIP-X2MPAUAL – Box Camera

Appearance and cable identification may vary between each model.

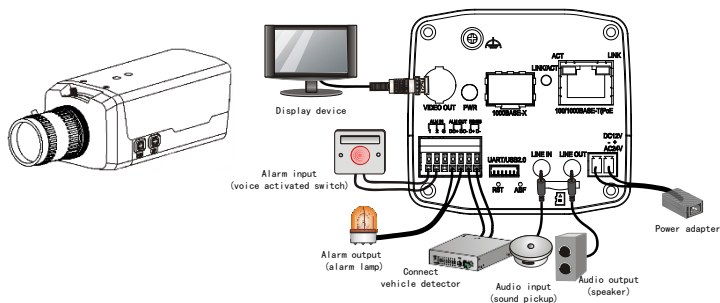

Interface	Description
	Grounding terminal
VIDEO OUT	BNC, outputs compound video signals
PWR	System status indicator
1000BASE-X	Unsupported
LINK/ACT	Ethernet link status indicator: Steady on: Connection established. Blinking: Data transmission.
ACT	Ethernet data transmission indicator
LINK	Ethernet network connection indicator
POE	Ethernet interface
ALM IN/OUT	Alarm input/output (refer to separate image)
RS485	RS485 serial port
UART/USB2.0	UART interface for UART and USB connection
LINE IN/OUT	Audio input/output
DC/AC	Power connector, DC 12V/AC 24V
RST	RST button
ABF	ABF button (for adjusting the back focus) Note: Fine-tune the back focus to get clear images.
SD	Micro SD card slot (refer separate image)

Alarm In\Out and 485

Refer to enlarged drawing of the cameras alarm and 485 terminal designations on the right for the correct wiring of alarms etc.

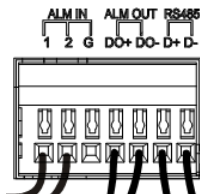

P-plug Pin Designation

Refer below for pin designation.

Interface	Description
<p>IRIS</p>	Iris control interface
<p>ZOOM</p>	Zoom control interface 1. ZOOM_A- 2. ZOOM_A+ 3. ZOOM_B- 4. ZOOM_B+
<p>FOCUS</p>	Focus control interface 1. FOCUS_A- 2. FOCUS_A+ 3. FOCUS_B- 4. FOCUS_B+
<p>Z/F</p>	Zoom/Focus control interface 1. FOCUS+ 2. FOCUS- 3. ZOOM+ 4. ZOOM-

(Optional) Insert Micro SD Card

Insert SD card into slot for local storage function – remove cover (right), then insert card (below). Refit cover. Hot plugging is not recommended. Power off first!

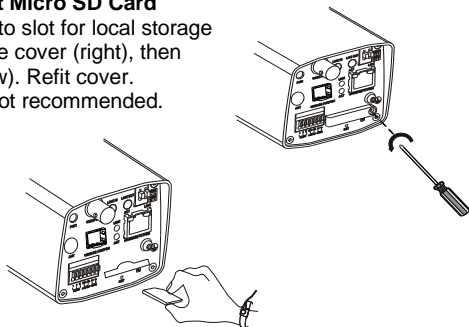

Your box camera can be fitted to any compatible wall bracket or external housing. Contact Vista Sales for possible options.

Below are example installations.

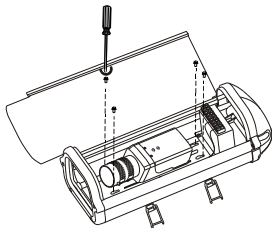
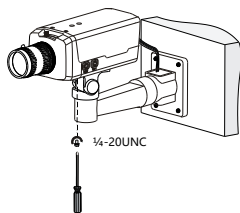

Once your box camera is fitted to your required bracket or housing and all required cables have been connected, refer to the section titled **4. Power-up and Access Camera**

4. Power-up and Access Camera

After installing camera, connect either PoE Ethernet or Ethernet & 12VDC PSU with correct power rating for the camera. Refer to following table for power details later in this guide.

DHCP is enabled as default. However, if no DHCP server is found, camera will default as below;

Default IP address = **192.168.1.13**
Default login = admin/123456

Connect suitable laptop to same LAN\VLAN and either set to DHCP or an IP address in the range **192.168.1.x** (but not **192.168.1.13!**).

1. Either open Web browser on laptop and enter the camera's IP address in the address bar, press Enter.
2. Or use the QR code provided to download the **Vizion Discovery** IP camera discover tool onto the Laptop.
3. Follow on-screen instructions to permit and instal any required plug-in.
4. Login to camera with ID and password – use the default provided earlier. Ensure you change to a strong password after first logging in!

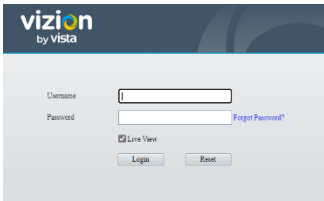

The screenshot shows the login page for a Vizion camera. At the top, the logo 'vizion by vista' is displayed. Below the logo, there are two input fields: 'Username' and 'Password'. To the right of the 'Password' field is a link that says 'Forgot Password?'. Below the input fields is a checkbox labeled 'Live View' which is checked. At the bottom, there are two buttons: 'Login' and 'Reset'.

5. Refer to example [Network] menu below and make any static IP address changes required.

The screenshot shows a web-based configuration interface for a device. At the top, there is a dark blue header bar with four tabs: 'Live View' (with a camera icon), 'Playback' (with a calendar icon), 'Photo' (with a photo icon), and 'Setup' (with a gear icon). The 'Setup' tab is currently selected. Below the header, the interface is divided into two main sections. On the left is a vertical sidebar menu with a 'Common' header and several sub-items: 'Basic Info', 'Local Parameters', 'Network' (which is highlighted with a blue arrow and text), 'Time', 'Server', 'OSD', and 'User'. Below these are several other menu items: 'Network', 'Video & Audio', 'Image', 'Intelligent', 'Events', 'Storage', 'Security', and 'System'. The main content area on the right is titled 'Network' and contains three expandable sections. The 'IPv4' section is expanded, showing 'Obtain IP Address' set to 'DHCP' via a dropdown menu. The 'IPv6' section is also expanded, showing 'Mode' set to 'DHCP' via a dropdown menu. The 'Basic' section is expanded, showing 'MTU' set to '1500' in a text field, 'Port Type' set to 'FE Port' in a dropdown menu, and 'Operating Mode' set to 'Auto-negotiation' in a dropdown menu. At the bottom of the 'Network' section, there is a blue 'Save' button.

Live View Playback Photo Setup

Common

- Basic Info
- Local Parameters
- ▶ Network
- Time
- Server
- OSD
- User

Network

Video & Audio

Image

Intelligent

Events

Storage

Security

System

IPv4

Obtain IP Address DHCP

IPv6

Mode DHCP

Basic

MTU 1500

Port Type FE Port

Operating Mode Auto-negotiation

Save

Power Requirements per Camera Model

CAMERA MODEL	PoE 802.3af	PSU Minimum
VIP-B2MP27V135IRAUAL	8.5W	12VDC @ 2Amp
VIP-B5MP28V12IRM	9.6W	12VDC @ 2Amp
VIP-B5MP27V135IRAUAL	8.0W	12VDC @ 2Amp
VIP-B8MP28V12IRAUAL	10.5	12VDC @ 2Amp
VIP-B5MP28IRM	5.0	12VDC @ 1Amp
VIP-B8MP28IRMAUAL	10.5	12VDC @ 2Amp
VIP-B5MP28IRWLM	11.5W	12VDC @ 2Amp
VIP-B8MP28IRWLM	11.5W	12VDC @ 2Amp
VIP-X2MPAUAL	7.0W	12VDC @ 2Amp

This completes the procedure.

Carryout any individual camera settings required for your specific installation before adding the camera to you NVR recorder. Refer to the provided QR code for additional manuals and resources.

Factory Defaulting

Where the camera is provided with a hardware reset button (indicated in each camera model section previously in this guide) simply use a pin to press and hold the Reset button for 15-seconds to restore factory default settings. This operation must be performed within 10-minutes after the device is powered up, otherwise the reset will be ignored.



Where applicable, a Declaration of Conformity in accordance with Directives 2014/30/EU (EMC), 2014/35/EU (LVD), and 2015/863/EU RoHS(3) has been made and we declare the product compliant.

Where applicable, the requirements of the European law on the Restriction of Hazardous Substances (RoHS) directive: 2015/863/EU have been met and the product is without the hazardous substances cited in the directive.

Our CE EU-Authorised Representative: Comply Express Unipessoal LDA, StartUp Madeira - EV141, Campus da Penteada, 9020-105 Funchal, Madeira, Portugal"



Symbolizes that within the European Union the product must be collected separately at the product end-of-life. Do not dispose of these products as unsorted municipal waste.



A UK Declaration of Conformity in accordance with GB UKCA standards has been made. The manufacturer declares that the product supplied with this document is compliant with the provisions of the Electromagnetic Compatibility Regulations 016, and where applicable, the Electrical Equipment (Safety) Regulations 2016 Directives.

WARNING

This is a Class A product. In a domestic environment this product may cause radio interference in which case the user may be required to take adequate measures.

No liability will be accepted by Vista for any errors or omissions in this information and reserves the right to make changes to the product and its specification from time to time without prior notice.

Version History

Ver 1.5 - added -H version of bullet = VIP-B5MP28V12IRM

Ver 1.6 - added WLM bullets = VIP-B5MP28IRWLM & VIP-B8MP28IRWLM