



QUICK SETUP GUIDE

Vista i5 Gen 13 Windows 11 PC



VistaPC-i5-G13-4Mon-KBM **Quick Setup Guide**

Please read this manual thoroughly before use and keep it handy for future reference.

Before You Begin

Read all instructions and enclosed guides supplied before installing or operating this product.

You must have a basic knowledge of CCTV & IT systems and electrical wiring and products.

Technical Support

If you still have questions after referring to the manuals, please contact Vista Technical Support or use the products QR code provided:

+44 (0) 118 912 5125

**Norbain SD, Inspired, Easthampstead Road,
Bracknell , Berkshire RG12 1YQ. UK**



Packing List

- | | | |
|----------------------|---------------------------|---------------------------|
| ➤ Motherboard Manual | ➤ 2 SATA Data Leads | ➤ Asus WiFi Antenna |
| ➤ GPU Install Manual | ➤ Chassis manual | ➤ Microsoft DVD Agreement |
| ➤ HDD screws | ➤ Processor Install Guide | |



*** WARNING:** Improper use can cause severe bodily injury or equipment damage.



**** Caution:** Improper use can cause equipment damage.



**RoHS
COMPLIANT**

Where applicable, a Declaration of Conformity in accordance with Directives 2014/30/EU (EMC), 2014/35/EU (LVD), and 2015/863/EU RoHS(3) has been made and we declare the product compliant.

Where applicable, the requirements of the European law on the Restriction of Hazardous Substances (RoHS) directive: 2015/863/EU have been met and the product is without the hazardous substances cited in the directive.

Our CE EU-Authorised Representative: Comply Express Unipessoal LDA, StartUp Madeira - EV141, Campus da Penteada, 9020-105 Funchal, Madeira, Portugal"



Symbolizes that within the European Union the product must be collected separately at the product end-of-life. Do not dispose of these products as unsorted municipal waste.



A UK Declaration of Conformity in accordance with GB UKCA standards has been made. The manufacturer declares that the product supplied with this document is compliant with the provisions of the Electromagnetic Compatibility Regulations 016, and where applicable, the Electrical Equipment (Safety) Regulations 2016 Directives.

Norbain SD, Inspired, Easthampstead Road, Bracknell , Berkshire RG12 1YQ. UK

1. Introduction

Thank you for purchasing the Vista i5 13th Generation Intel/Windows PC.

The PC provides the flexibility to be specified, at the point of purchase, for use as either a mid-range IP-CCTV viewing client or video storage server for your chosen Windows-based VMS. Refer to the VMS manufacturer's technical details and requirements for suitability.

Windows 11 64-bit Pro is part-installed to the latest Solid State Drive (M.2) and simply requires final completion of the Out Of Box Experience with your chosen settings and preferences.

2. Out Of Box Experience

Unpack the PC and connect to a monitor, mouse, keyboard and network connection. Power up.

- OOBE may first check for MS Updates.
- Set region as required.
- Set a name for the PC – if required (below left).
- Either create, or enter existing details for a Microsoft account (below right).

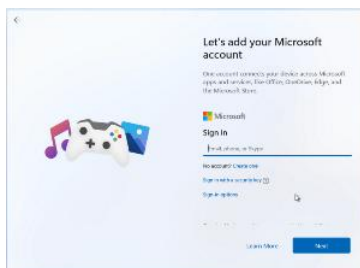
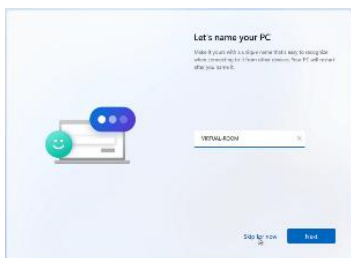

Important: Keep details of all accounts and passwords you create! Vista are unable to recover passwords for you if lost and re-imaging of the PC may then be required!

- If prompted, set a PIN and keep a note of it.
- Select whether to restore from a previous PC or Setup as a New Device.
- Choose your required Privacy Settings (below left)

- Set or [skip] in customizing the Microsoft Experience (below right)

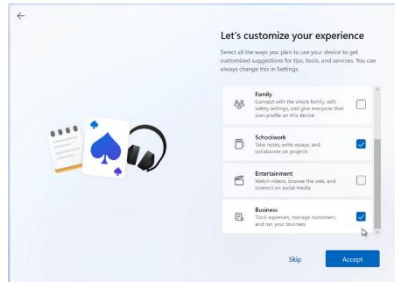
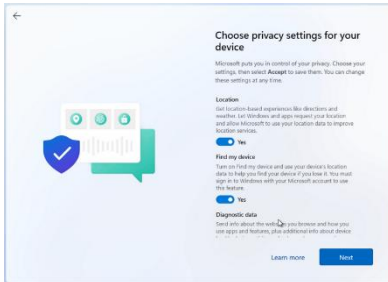

- Select whether to store files in OneDrive or local to the PC
- Eventually, Windows 11 will complete its OOB E dialogue and commence final setup with the below screen and may take some time.

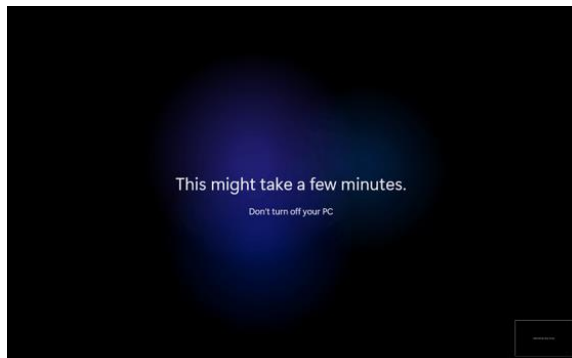

Once Windows 11 finally completes its setup and reboots, login with the account details you previously entered. We recommend you also complete the below tasks;

- Create additional IDs and passwords for users, installers and own recover account.
- Connect to Internet and ensure Microsoft Updates are performed and up to date.
- Confirm all installed HDDs are present and formatted as required for your VMS.

This completes the procedure

Western Digital 10TB HDD – Fitting Issue and Resolution

Later Western Digital 10TB HDDs may be missing 2-pairs of screw hole positions for fixing into a PCs chassis – 1-pair on the side fixing (below left) and one pair on the underside (below right).

In such a scenario, please follow the procedure to modify the Vista i5 plastic HDD caddy.



WD Absent Side Fixings



WD Absent Underside Fixings

1. Place caddy on worktop with the orientation shown in the below left image and with a craft knife, cut and remove the indicated pins.
2. Flip and place caddy on top of the HDD with the orientation shown in the below right – ensuring the two remaining side pins locate with the side holes of the HDD correctly.
3. Finally, fix with two screws as shown below right.

