

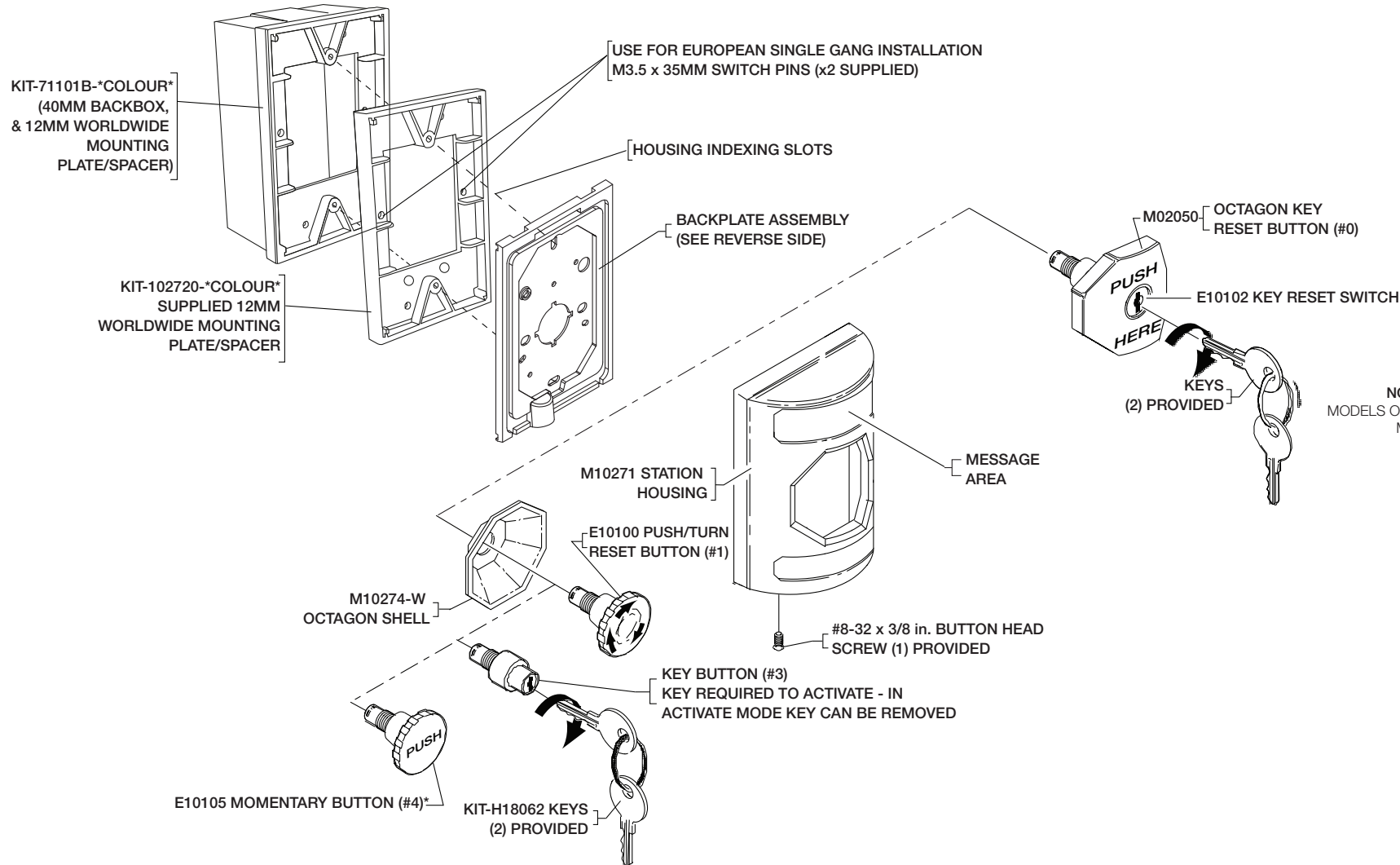

Safety Technology International

European Office
Taylor House • 34 Sherwood Road • Bromsgrove
Worcestershire • B60 3DR • England
Tel: 44 (0) 1527 520 999 Fax: 44 (0) 1527 501 999
E-mail: info@sti-emea.com • Web: www.sti-emea.com

USA - Headquarters
2306 Airport Road • Waterford, Michigan 48327-1209
Phone: 248-673-9898 • Fax: 248-673-1246
E-mail: info@sti-usa.com • Web: www.sti-usa.com



PRODUCT DIMENSIONS

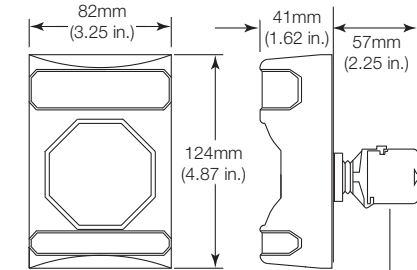

NOTE: MODELS REQUIRE KIT-71101B-*COLOUR*
MODELS ONLY SUITABLE FOR EXTENDED DEPTH SURFACE MOUNTING DUE TO DIMENSIONS OF CONTACTS

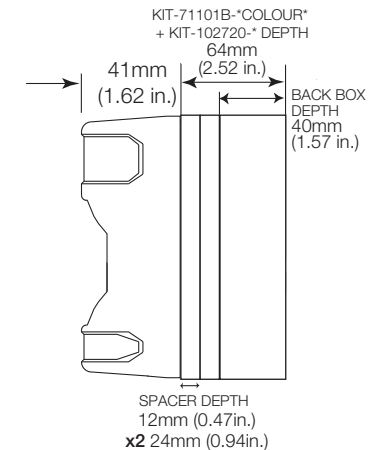

*SS-2**4 and LT1 NOTES: For access control installations, power for the LT-1UL Timer must be supplied by a power source listed to UL294. When used for access control, this device shall be used as part of an access controlled egress door system. It is up to the local AHJ to allow use of this device in place of an automatic sensor. For higher security installations, lower time limits should be used. For SS-2** and LT1-UL the enclosed timer is to be used and installed per the enclosed LT-1UL installation sheet. SS-2**4 and LT1-UL maximum rating 30 VDC 3A.

WARNING: This product can expose you to chemicals including Dichloromethane, which is known to the State of California to cause cancer, and Bisphenol A (BPA) which is known to the State of California to cause birth defects or other reproductive harm. For more information go to www.P65Warnings.ca.gov.

INSTALLATION OF SS2xx0, 2xx1, 2xx3 and 2xx4 SERIES STOPPER® STATION

All specifications and information shown were current as of publication, and are subject to change without notice



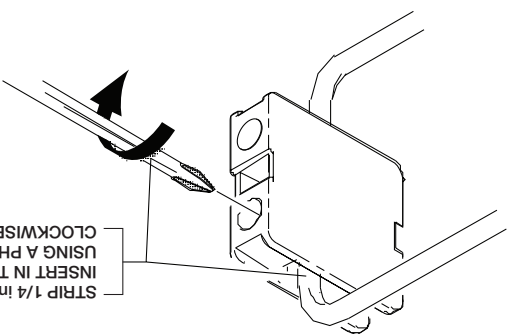

SEPARATION OF TERMINAL ASSEMBLY.
FROM BUTTON ASSEMBLY IS AS FOLLOWS:
GRASP TERMINAL HOUSING AND USING THUMB
APPLY PRESSURE DOWNWARD, REMOVE TERMINAL.

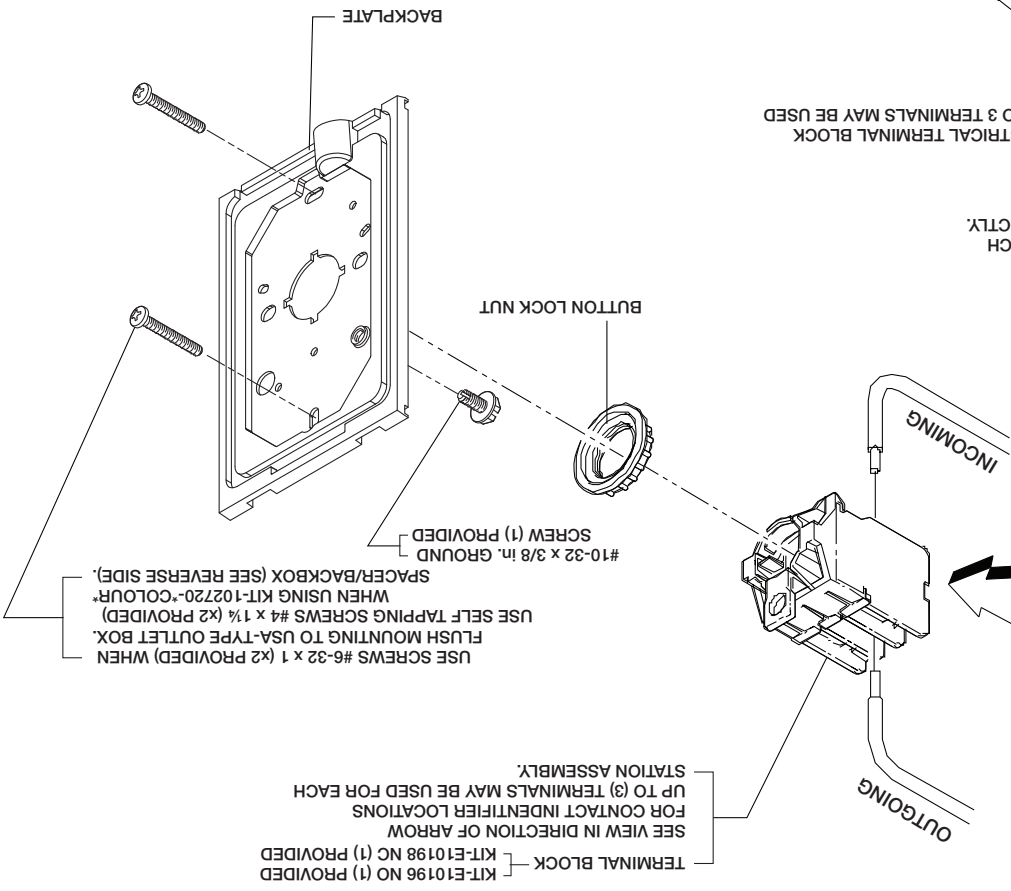
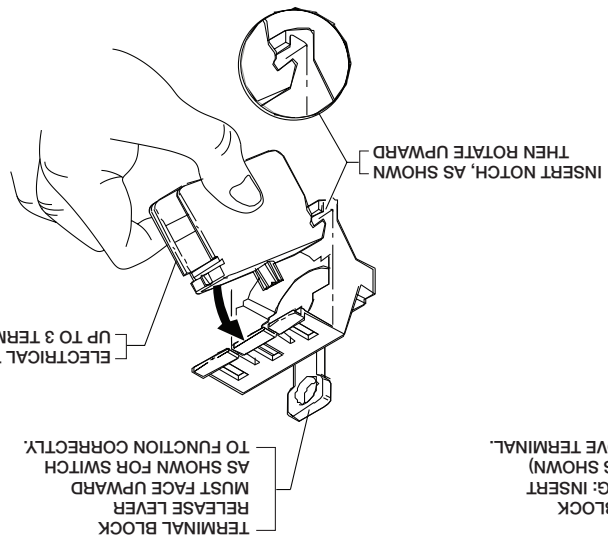
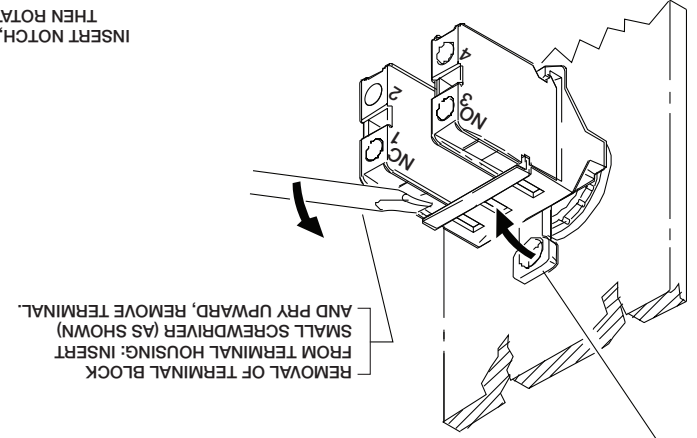

ALL TERMINALS ACCEPT TWO 12 TO 18 (AWG)	
VOLTAGE RATED	250 VDC
AVERAGE CURRENT	1 AMP
	3 AMP
	600 VAC

NOTE: SS2xx4/LT CONTACTS ON FORM C TIMER RATED: 120 VAC, 3A
28 VDC, 3A

INSTALLATION OF SS2xx0, 2xx1, 2xx3 and 2xx4 SERIES STOPPER®STATION All specifications and information shown were current as of publication, and are subject to change without notice